

VenusLiv User Manual

V2.0.0

Packing List

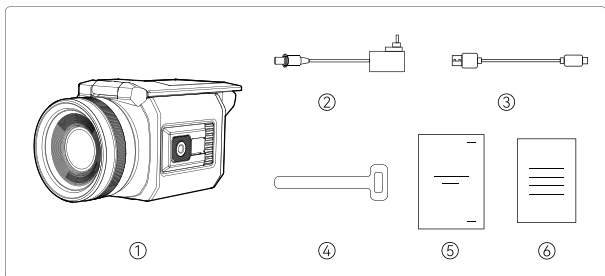

① VenusLiv	x1
② 12V 2A Adapter	x1
③ USB Cable	x1
④ Cable Tie	x1
⑤ User Manual	x1
⑥ Warranty Card	x1

Parts Description

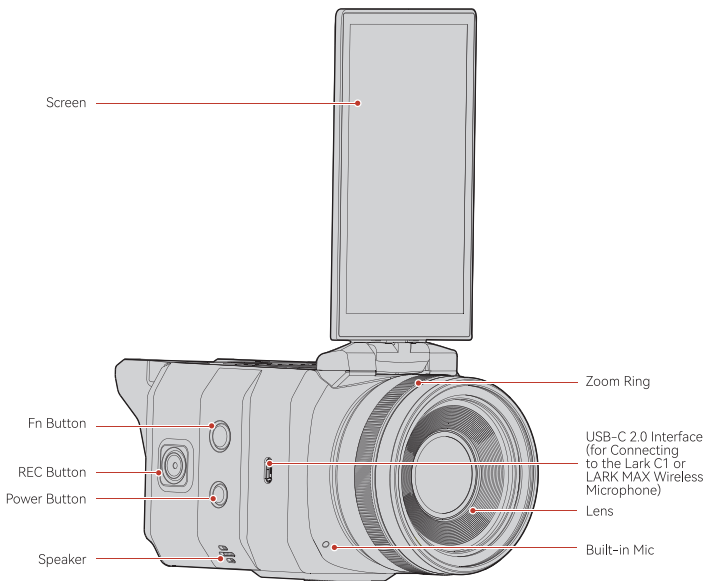

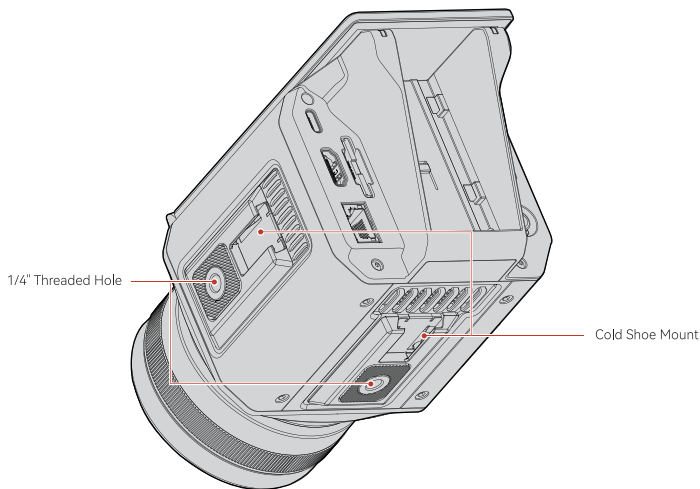
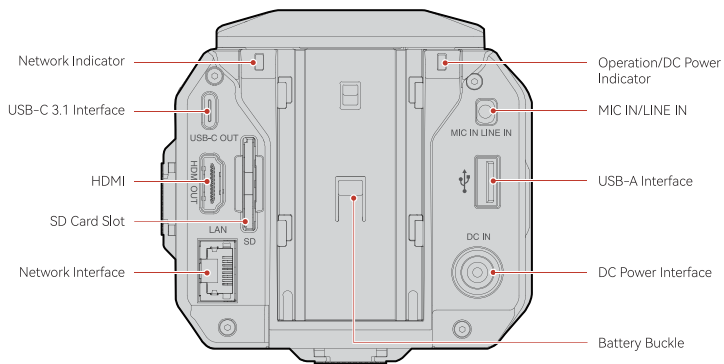

Parts Functions

Power Button

Press and hold the button for 3 seconds to turn on or off the camera.

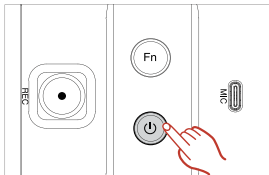

Fn Button

Press the button to switch between the live scenes.

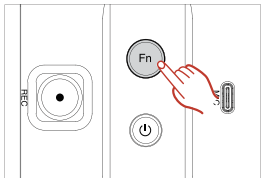

REC Button

- Live mode: Press the button to start live broadcasting.

Note:

A network connection and streaming URL are required to start live broadcasting.

- Photo mode: Press the button to take photos.

Note:

A storage device is required to take photos.

- Video mode: Press the button to take videos.

Note:

A storage device is required to take videos.

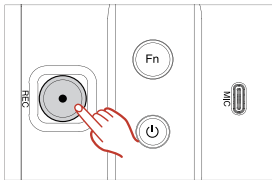

USB-C 2.0 Interface for Connecting to the Lark C1 or LARK MAX Wireless Microphone

The interface supports connecting to the Lark C1 or LARK MAX wireless microphone. Compatibility issues may be caused when audio devices with other USB-C interfaces are connected.

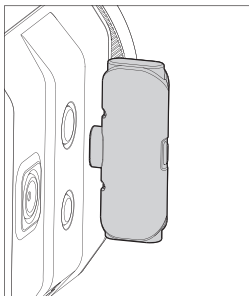

USB-C 3.1 Interface for Performing UVC Streaming

The interface supports connecting to a PC via a USB cable to transmit audio & video streams.

Note:

Please use the original USB-C 3.0 cable. Cables lower than USB-C 3.0 may not support the transmission of your audio & video streams.

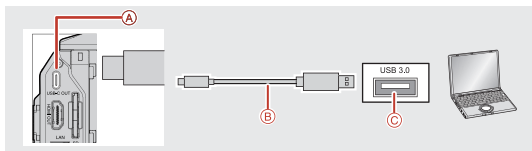

HDMI

HDMI Same-Screen Output:

When the camera is connected to a monitor, the camera UI can be synchronously displayed on the monitor for monitoring.

HDMI Content-Only Output:

When the camera is connected to a broadcasting station or monitor, audio & video streams can be output for streaming.

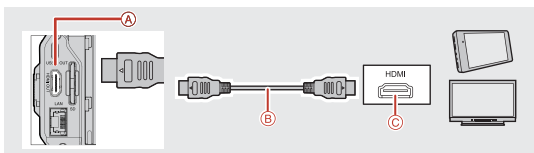

RJ45 Interface

The interface is used for connecting to the network and performing streaming.

Green light: The camera is properly connected to the network.

Red light: The camera is not connected to the network.

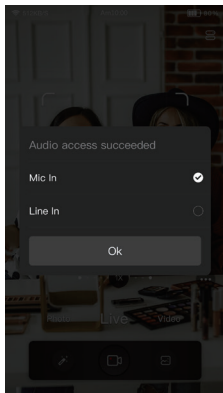
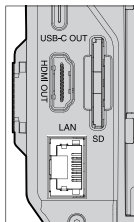

3.5mm Interface

The interface is used for connecting to a three-section LINE IN or MIC IN device.

Note:

When a LINE IN or MIC IN device is connected, please select the corresponding mode. Otherwise, abnormal audio reception or even no audio reception may be caused.

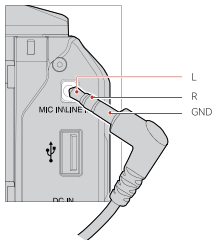

USB-A Interface

The interface is used for connecting to a USB flash drive to store photos or videos or connecting to a mouse or keyboard to operate the camera.

Note:

1. Do not unplug the USB flash drive when the camera is transmitting or accessing information. Otherwise, data may be lost or damaged, or even the USB flash drive or camera may be damaged. Before replacing or unplugging the USB flash drive, please turn off the camera. The losses caused by the use of a damaged USB flash drive, including data loss, cannot be recovered.
2. When shooting videos, please use a class 10 USB flash drive or above to store videos. The maximum size of a video file is 4GB.

3. If you are prompted that you do not have full permission to use the USB flash drive to store data, please check or replace the USB flash drive.



SD Card Slot

• Inserting the SD card

Insert the SD card until it clicks into place. Please insert the SD card correctly to avoid a malfunction.

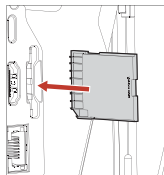

• Removing the SD card

Push in the SD card lightly once to remove it.

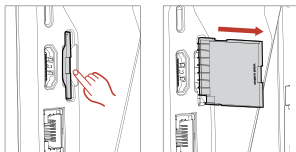

DC Power Interface

Power adapter interface. It is strongly recommended to use the original adapter to avoid the risk of camera damage.

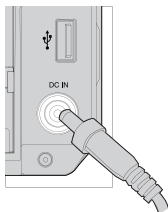

Note:

1. Do not remove the SD card when the camera is transmitting or accessing information. Otherwise, data may be lost or damaged, or even the SD card or camera may be damaged. Before replacing or removing the SD card, please turn off the camera. The losses caused by the use of a damaged SD card, including data loss, cannot be recovered.
2. When shooting videos, please use a class 10 SD card or above to store videos. The maximum size of a video file is 4GB.
3. If you are prompted that you do not have full permission to use the SD card to store data, please check or replace the SD card.

Battery Slot

- **Installing the battery**
Align the battery contact point with the battery connection seat in the battery slot and insert the battery into the battery slot.

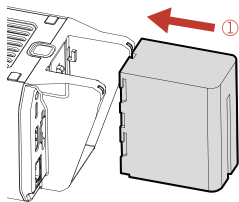

- **Removing the battery**

- ① Press and hold the battery release button.
- ② Push up the battery to remove it.

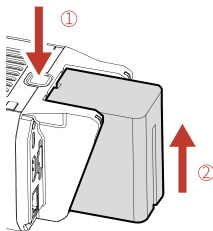
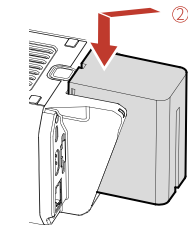

1/4" Threaded Hole

Used for installing the camera horizontally or vertically.

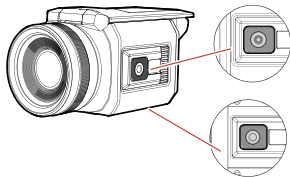

Cold Shoe Mount

Used for mounting external devices.

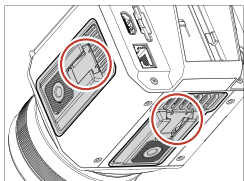

Zoom Ring

- Rotate the zoom ring clockwise to reduce the focal distance.
- Rotate the zoom ring counterclockwise to increase the focal distance.

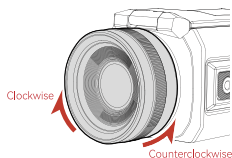

Screen

- **Up**
The screen can only open to 180°. Be careful not to open the screen any further than this.
- **Left**
The screen can only open to 180°. Be careful not to open the screen any further than this.
- **Right**
The screen can only open to 130°. Be careful not to open the screen any further than this.

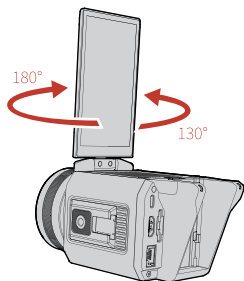
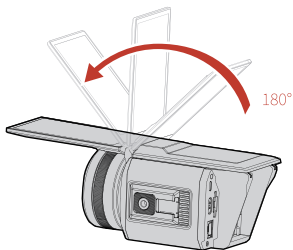

UVC Streaming

1. Connect the camera to a computer via a USB cable. (Note: The USB interface on the computer and the USB cable are required to support the USB-C 3.0 standard.)
2. Open streaming software or live broadcasting software on the computer.
3. Select devices.
 - Select **HOLLYLAND FHD Camera** as the camera.
 - Select **HOLLYLAND** as the audio device.

Streaming to a Broadcasting Station via an HDMI Cable

1. Connect the camera to a broadcasting station via an HDMI cable. (Note: The HDMI cable is required to support HDMI 1.4 or above.)
2. Select **HDMI Content-Only Output** in the dialog box that is displayed. (Note: **HDMI Same-Screen Output** is not recommended for streaming.)
3. Enter the corresponding streaming URL after the camera video streams and sound are displayed on the broadcasting station. (Note: The broadcasting station needs to be connected to the network.)
4. Tap **Live** on the broadcasting station to start streaming.

Connecting to a Monitor via an HDMI Cable

1. Connect the camera to a monitor via an HDMI cable. (Note: The HDMI cable is required to support HDMI 1.4 or above.)
2. Select **HDMI Same-Screen Output** or **HDMI Content-Only Output** in the dialog box that is displayed.
3. The connection is successful after the camera video streams and sound are displayed on the monitor.

Home Screen

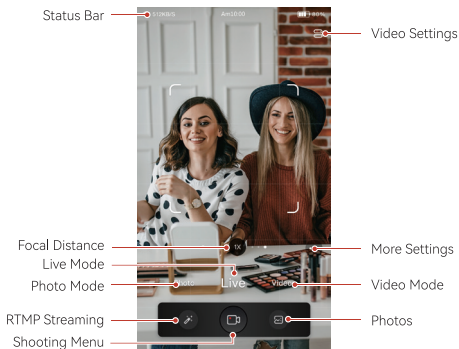















Navigation





1. Swipe down from the top to enter the quick settings interface.
2. Swipe up from the bottom to enter the main interface.
3. Swipe left or right to return to the previous interface.

Status Icon Description

	The camera is using an Ethernet network.
	The camera is using a Wi-Fi network.
	No network currently.
Am 10:00 Current time.	
	The audio device connected to the camera is the Lark C1 or LARK MAX wireless microphone.
	The audio device connected to the camera is a MIC IN device.
	The audio device connected to the camera is a LINE IN device.
	An SD card has been inserted into the camera.
	A USB device has been inserted into the camera.
	UVC streaming is in progress.
	Only USB-C connection currently.
	The camera is connected to a device via an HDMI cable.
	Camera Bluetooth is enabled.
	The camera is powered by a power source other than a battery.
	The camera is powered by a battery.

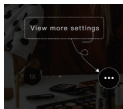
More Settings



Tap  to view more functions and parameters, including screen rotation, live scenes, and Pro parameters.

Streaming URL

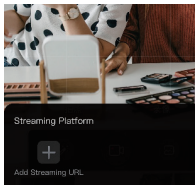

There are two ways to add a streaming URL.

Method 1: Scan the QR code on a mobile phone, enter the streaming name and streaming URL, and tap **Submit**. The information will be synchronized to the camera. Then tap **Finish** on the camera.

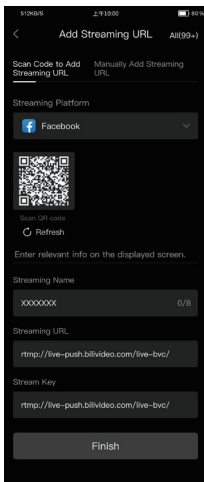

Method 2: Tap **Manually Add Streaming URL**, enter the streaming name and streaming URL, and then tap **Finish**.

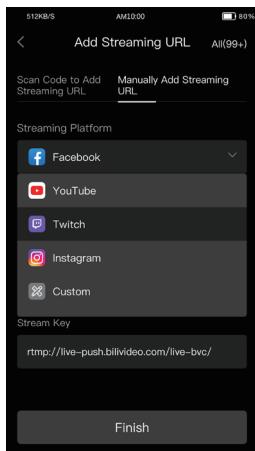

Streaming URL

The streaming server address and stream key are required for entering the streaming URL.

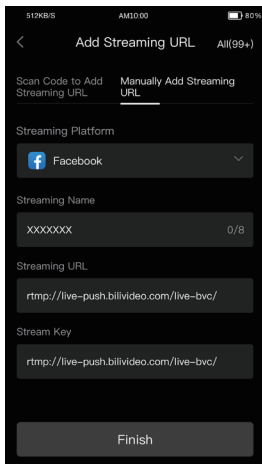

The screenshot shows a mobile application interface for adding a streaming URL. At the top, the status bar displays '512KB/S', 'AM10:00', and '80%' battery. The app title is 'Add Streaming URL' with a back arrow on the left and 'All(99+)' on the right. Below the title, there are two tabs: 'Scan Code to Add Streaming URL' and 'Manually Add Streaming URL', with the latter being selected. The form contains the following fields:

- Streaming Platform:** A dropdown menu currently set to 'Facebook'.
- Streaming Name:** A text input field containing 'XXXXXXX' with a character count of '0/8'.
- Streaming URL:** A text input field containing 'rtmp://live-push.bilibili.com/live-bvc/'.
- Stream Key:** A text input field containing 'rtmp://live-push.bilibili.com/live-bvc/'.

At the bottom of the form is a large 'Finish' button.

Live Scene

The camera supports multiple live scenes.

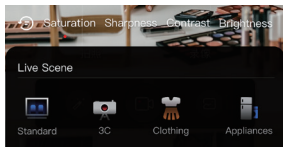

Pro Parameters

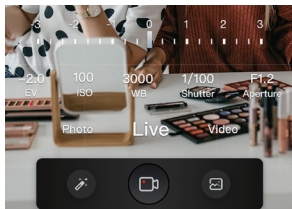

EV	Adjust the exposure compensation.
ISO	Adjust the camera sensitivity.
WB	Adjust the white balance.
Shutter	Adjust the shutter speed.
Aperture	Adjust the camera aperture.

Pro Parameter Settings

EV

Range: -3 to 3

Adjust the exposure compensation:

Tap EV and tap or slide the EV adjustment area.

Note:

When either the ISO or the shutter is in the AUTO mode, the EV can be adjusted. When neither the ISO nor the shutter is in the AUTO mode, the EV cannot be adjusted.

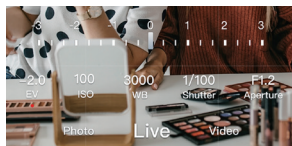

ISO

Range: 100 to 6400

Adjust the camera sensitivity:

Automatic (A): The camera automatically adjusts the sensitivity according to the environment.

Manual: Tap ISO and tap or slide the ISO adjustment area.

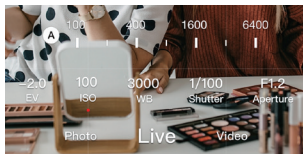

WB

Range: 3000 to 7000

Adjust the white balance:

Automatic (A): The camera automatically adjusts the white balance according to the environment.

Manual: Adjust the white balance according to the actual live broadcasting environment.

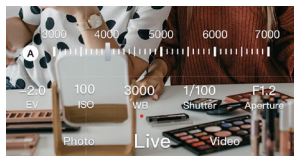

Shutter

Adjust the shutter speed:

Tap **Shutter** and select a shutter speed.



Aperture

Range: F1.2, F1.6, F2.0

Adjust the aperture:

Tap **Aperture** and select an aperture value.

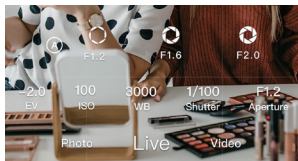



Video Settings

Enter the video settings:

In the live mode or video mode, tap  in the upper right corner.

Resolution

Adjust the video resolution:

Go to  >  and select a desired resolution. A higher resolution in the live mode requires a larger bandwidth, and a higher resolution in the video mode generates a larger video file.



Bit Rate

Adjust the bit rate:

Go to  >  and select a desired bit rate.

Video Saving Interval

Adjust the video saving interval:

Go to  >  and select a desired video saving interval. The settings take effect only in the video mode.

Zoom Range

Range: 1x to 6x

Adjust the zoom range:

Method 1: Select a zoom value.



Method 2: Pinch to zoom in or out.

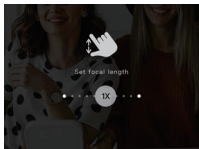

Method 3: Rotate the zoom ring to adjust the focal distance.

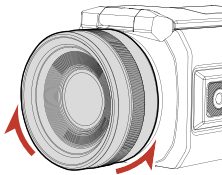

Note:

The focal distance in the live, photo, and video modes is the same.

Anti Banding

Select a proper frequency option to avoid camera flickering in the light.

Camera Modes

Photo Mode

Tap the shooting menu to take photos.

Video Mode

Tap the shooting menu to take videos.

Note:

Because photos and videos can only be stored on external devices, an SD card or USB flash drive is required when you are taking photos or videos. You can view the corresponding files in the photos or files.

RTMP Live Mode

Tap the shooting menu to start live broadcasting.

Note:

The prerequisites for starting live broadcasting are as follows:

1. The camera has been connected to an Ethernet or Wi-Fi network.
2. A streaming URL has been added.

Quick Settings

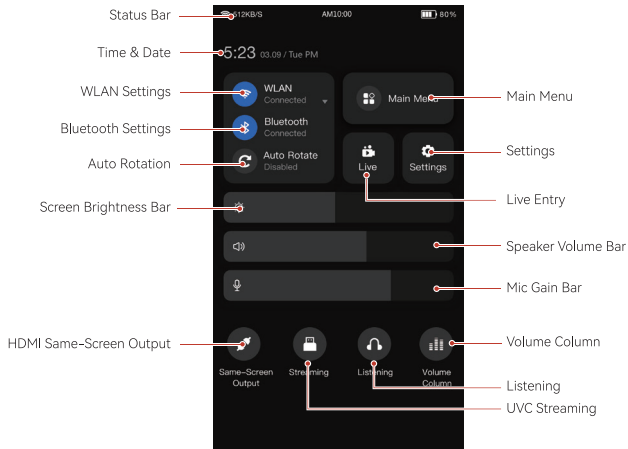

WLAN Settings

Tap the icon to turn the WLAN function on or off, or tap and hold the icon to enter the WLAN interface.

Bluetooth Settings

Tap the icon to turn the Bluetooth function on or off, or tap and hold the icon to enter the Bluetooth interface.

Auto Rotation

Tap the icon to turn the auto rotation function on or off.

Screen Brightness Bar

Move the slider to adjust the screen brightness.

Speaker Volume Bar

Move the slider to adjust the speaker volume.

Mic Gain Bar

Move the slider to adjust the mic gain.

HDMI Same-Screen Output

After the camera is connected to a device via an HDMI cable, swipe down to enter the quick settings interface and tap the **Same-Screen Output** icon. You can switch between **HDMI Same-Screen Output** and **HDMI Content-Screen Only Output**.

Settings

Swipe down to enter the quick settings interface and tap the **Settings** icon to enter the camera settings interface.

Live Entry

Swipe down to enter the quick settings interface and tap the **Live** icon to enter the live interface.

UVC Streaming

After the camera is connected to a device via a USB-C 3.0 cable, swipe down to enter the quick settings interface and tap the **Streaming** icon to enter the UVC streaming mode.

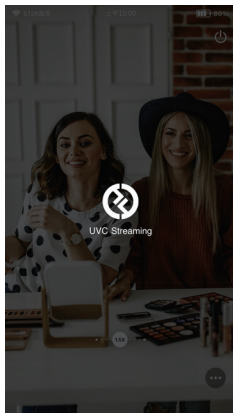

Main Menu

Swipe down to enter the quick settings interface and tap the **Main Menu** icon to enter the main menu interface. Tap an app on the main menu interface to enter the app.

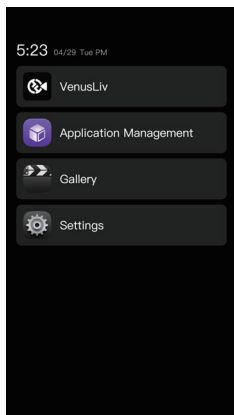

Volume Column

Swipe down to enter the quick settings interface and tap the **Volume Column** icon to turn the function on or off. You can monitor the audio gain in the live mode or video mode.

Listening

Swipe down to enter the quick settings interface and tap the **Listening** icon to enter the listening mode.

Settings

Connecting to a WLAN

1. Go to **Settings > WLAN** and turn on the WLAN function.
2. On the WLAN settings interface, choose the WLAN to be connected from the available WLAN list. If an encrypted network is selected, a password is required.

Deleting a WLAN

1. Go to **Settings > WLAN** and turn on the WLAN function.
2. Tap and hold the WLAN to be deleted in the connected WLAN list and tap **Delete**.

Wired Network

Go to **Settings > Wired Network** and turn on or off the wired network function.

The wired network function is turned on by default. When a network cable is inserted into the camera, the camera automatically connects to the network.

Entering an IP Address Manually

Go to **Settings > Wired Network**, turn off the **Obtain IP Address Automatically** function, enter a desired IP address, subnet mask, and default gateway, and tap **Save**. If the **Obtain IP Address Automatically** function is turned on, the IP address, subnet mask, and default gateway will be obtained automatically by default.

Entering a DNS Server Address Manually

Go to **Settings > Wired Network**, turn off the **Obtain DNS Server Address Automatically** function, enter a desired preferred DNS server address and alternate DNS server address, and tap **Save**. If the **Obtain DNS Server Address Automatically** function is turned on, the preferred DNS server address and alternate DNS server address will be obtained automatically by default.

Bluetooth

Go to **Settings > Bluetooth** and turn on or off the Bluetooth function.

Changing the device Bluetooth name:

1. Go to **Settings > Bluetooth** and turn on the Bluetooth function.
2. Tap the device Bluetooth name, enter a new name, and tap **OK**.

Connecting to a Bluetooth device:

1. Turn on a Bluetooth device and make sure it is discoverable.
2. Go to **Settings > Bluetooth** and turn on the Bluetooth function. Then, the camera automatically searches for available Bluetooth devices.
3. Choose the device to be connected in the available Bluetooth device list and complete pairing as prompted.

Disconnecting from a Bluetooth device:

1. Go to **Settings > Bluetooth** and turn on the Bluetooth function.
2. Tap and hold the Bluetooth device to be disconnected in the connected Bluetooth device list and tap **Delete**.

App Management

- **Opening an app**
Go to **Settings > App Management** and tap the app to be opened.
- **Updating an app**
Go to **Settings > App Management** and tap the app to be updated.

Volume & Brightness Adjustment

Go to **Settings > Sound & Brightness** to adjust the screen brightness and volume.

- **Adjusting the screen brightness**
Move the slider on the screen brightness bar to adjust the screen brightness.
- **Adjusting the volume**
Move the slider on the speaker volume bar to adjust the speaker volume.
Move the slider on the mic gain bar to adjust the mic gain.

Storage

- **Clearing camera cache**
Go to **Settings > Storage** and tap **Clear** to clear the camera cache.
- **Deleting app data**
Go to **Settings > Storage**, tap an app to enter the app management interface, and tap **Delete Data**.
- **Clearing app cache**
Go to **Settings > Storage**, tap an app to enter the app management interface, and tap **Clear Cache**.
- **Memory**
Installed systems and software occupy some memory.

File Management

You can view photos and videos on the storage devices.

System & Update

System Upgrade

When a new version is released, the camera will prompt you to download and install the latest firmware to upgrade the system.

Note:

Keep the power adapter connected to the camera and do not cut off the power during the upgrade. If the upgrade fails and the camera cannot be used, please contact our after-sales personnel.

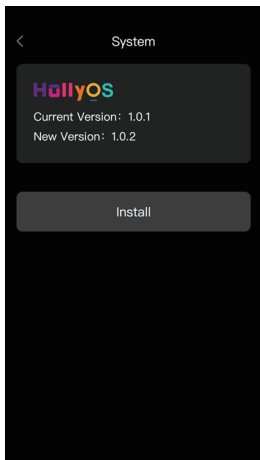

Language

Go to **Settings > System & Update > Language** and select a desired language.

Restoring Default Settings

Go to **Settings > System & Update > Restore**, tap **Reset Camera**, and reset the camera as prompted.

Note:

This operation will delete data from the internal storage of the camera (including account information, system & app data, and system settings). Please back up the data before performing this operation to avoid data loss.

About Camera

You can view the basic information and legal information of the camera.

Photos

Photo Interface

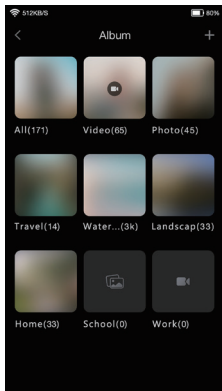

File Details

You can tap a photo or video and view it in full screen. You can also tap the screen again to hide the menu.

When you are viewing a photo or video in full screen, you can tap  to view parameter information such as the storage path, resolution, and size of the photo or video in the popup menu that is displayed.

Moving Photos & Videos

1. Tap the photo or video to be moved.
2. Tap **Move** and select an album or create an album to which the photo or video is to be moved.
3. After the file is moved, it will no longer be stored in the original album.

Renaming Photos & Videos

1. Tap the photo or video to be renamed.
2. Tap **Rename** and enter a new name.
3. Tap **OK**.

Deleting Photos & Videos

Tap the photo or video to be deleted (tap and hold the file to select multiple files), tap **Delete**, and then tap **OK**.

Note:

Deleted photos or videos cannot be restored.

Creating an Album

1. Go to photos and enter the album interface.
2. Tap **+**, enter a new album name, and tap **OK**.
3. Select the photo or video to be added to the new album and then move it to the album.

Sorting Photos & Videos

Go to photos, enter the album interface, and tap  in the upper right corner to start sorting. Sorting by creation time, file name, or file size in ascending or descending order is supported.

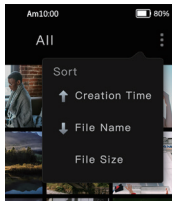

Status Indicators

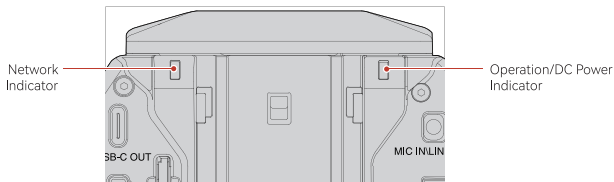

Network indicator light: Red/Green ■ ■

- Steady green light: Successful network connection
- Steady red light: Abnormal network connection
- Light OFF: Camera being initialized

Operation indicator light: Red/Green ■ ■

- Steady green light: Normal operation
- Green light flashing slowly: Camera being initialized
- Steady red light: Abnormal camera status
Example: Abnormal or full file storage, low battery, etc.
- Red light flashing slowly: Firmware upgrade in progress

DC power indicator: Yellow ■

- Yellow light ON: The camera is connected to a DC power adapter.
- Yellow light OFF: The camera is battery-powered/The camera is turned on.

Specifications

CPU	Qualcomm	
CMOS	Sony	
OS	HollyOS	
Weight	900g (31.7oz)	
Dimensions	(LxWxH): 178mmx99.7mmx94.8mm (7"x3.9"x3.7")	
Power Consumption	<12W	
Input Voltage	12V DC	
Wireless Technology	Wi-Fi: 2.4 GHz + 5 GHz	Bluetooth 5.0
Operating Temperature	-10° C to 40° C	
FOV	80° (Horizontal) / 46° (Vertical)	
Zoom	3x optical and 2x digital zoom	
Focus	Auto hybrid focus	
Touch Screen	5" LCD	1080x1920px
External Battery	NP-F batteries	
Interface	DC IN	DC interface with a threaded lock
	MIC IN/LINE IN	3.5mm
	HDMI OUT	Type A@HDMI 1.4
	SD card slot	SDIO3.0 @SDXC
	USB-C OUT	USB-C 3.1
	MIC	USB-C 2.0 for connecting to the Lark C1 or LARK MAX wireless microphone.
	USB-A	USB 2.0
	RJ45	1.0 Gbps

Camera Security

Warning:

If you fail to take the following precautions, you may be seriously injured or killed by the electric shock or fire disaster caused, or your VenusLiv may be damaged. Please check whether the camera and accessories are intact before using them. For security reasons, only Hollyland accessories that are provided with the camera or genuine ones purchased can be used. The use of any other parts, accessories, or chargers not recommended by Hollyland may cause fire disaster, electric shock, or personal injury. Damage caused by the use of unauthorized accessories is not covered by the warranty. For approved accessories, please visit the Hollyland official website at <https://www.hollyland.com>.

1. Do not touch the plug or adapter with wet hands when connecting the camera to the adapter. Failure to follow this precaution may cause electric shock.
2. Do not place or fix the camera on an unstable surface. Failure to follow this precaution may cause the camera loosen or fall off, causing an accident or damage to the camera.
3. When using external power supply connection, please follow all the security rules of the third-party power supply device.
4. The lens of the VenusLiv is made of glass. If the lens is damaged, please handle it carefully to avoid being scratched by the broken lens/glass and keep it away from children.
5. The temperature of the camera may rise during operation. If this occurs, turn off the camera and leave it to cool before using it again.
6. This product is not a toy and you are solely responsible for complying with all local laws, regulations, and restrictions.
7. Do not use the VenusLiv for unauthorized monitoring, candid shooting, or in any way that violates personal privacy regulations. Normally, it is strictly forbidden to use the camera for such purposes. If you fail to follow this precaution, you may bear huge responsibilities and face criminal proceedings.
8. Do not put the camera in extremely cold or hot environments. Extremely cold or hot environments may cause the camera to temporarily stop working properly.

Note:

There is no protection for the lens of the VenusLiv. If you do not pay attention to it, it is easy to cause scratches. Please store the VenusLiv in the provided box and avoid placing the lens on any surface. Lens scratches are not covered by the warranty.

Disclaimer

1. Please read and follow all the instructions carefully.
2. Please note all the warnings.
3. Do not use the product near heat sources such as radiators, electric heaters, stoves, or other heat-producing equipment.
4. Use only parts and accessories specified or provided by Hollyland.
5. Please hand over all maintenance work to qualified personnel. No matter what kind of damage the product suffers, such as damage to the power cable or plug, liquid penetration, objects falling into the product, rain, dampness, failure to work normally, or fall, maintenance is required.

Support

If you encounter any problems in using the product or need any help, please contact Hollyland Support Team via the following ways:



Hollyland User Group



HollylandTech



HollylandTech



HollylandTech



support@hollyland.com



www.hollyland.com

Statement

All copyrights belong to Shenzhen Hollyland Technology Co., Ltd. Without the written approval of Shenzhen Hollyland Technology Co., Ltd., no organization or individual may copy or reproduce part or all of any written or illustrative content and disseminate it in any form.

Trademark Statement

All the trademarks are owned by Shenzhen Hollyland Technology Co., Ltd.

Note:

Due to product version upgrades or other reasons, this User Manual will be updated from time to time. Unless otherwise agreed, this document is provided as a guide for use only. All representations, information, and recommendations in this document do not constitute warranties of any kind, express, or implied.

FCC Requirement

Any changes or modifications not expressly approved by the party responsible for compliance could void the user's authority to operate the equipment. This device complies with Part 15 of the FCC Rules. Operation is subject to the following two conditions: (1) this device may not cause harmful interference, and (2) this device must accept any interference received, including interference that may cause undesired operation.

FCC Radiation Exposure Statement:

The device has been tested and found to comply with FCC SAR limits.

Note:

This equipment has been tested and found to comply with the limits for a Class B digital device, pursuant to Part 15 of the FCC Rules. These limits are designed to provide reasonable protection against harmful interference in a residential installation. This equipment generates, uses, and can radiate radio frequency energy and, if not installed and used in accordance with the instructions, may cause harmful interference to radio communications. However, there is no guarantee that interference will not occur in a particular installation. If this equipment does cause harmful interference to radio or television reception, which can be determined by turning the equipment off and on, the user is encouraged to try to correct the interference by one or more of the following measures:

- Reorient or relocate the receiving antenna.
- Increase the separation between the equipment and receiver.
- Connect the equipment into an outlet on a circuit different from that to which the receiver is connected.
- Consult the dealer or an experienced radio/TV technician for help.

包裝清單

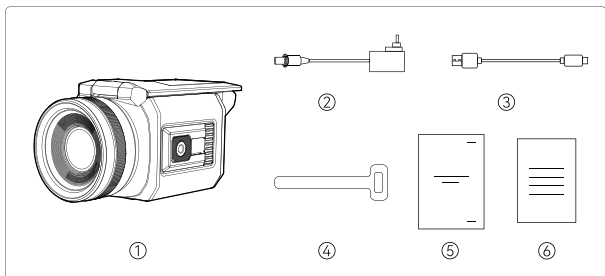

① VenusLiv	x1
② 12V 2A 轉接器	x1
③ USB 線	x1
④ 束線帶	x1
⑤ 使用者手冊	x1
⑥ 保固卡	x1

零件說明

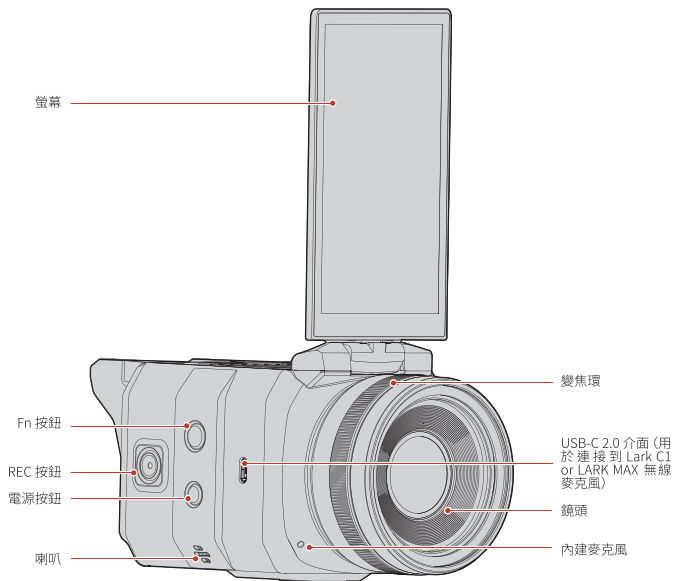

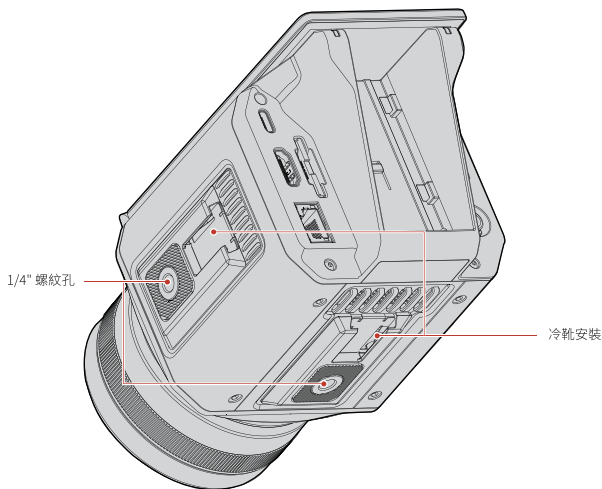
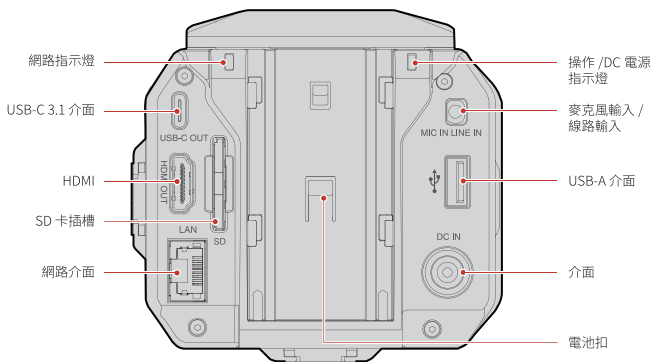

零件功能

電源按鈕

按住按鈕 3 秒即可開啟或關閉攝影機。

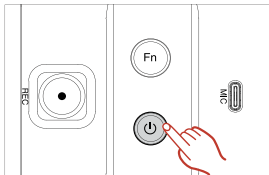

Fn 按鈕

按下按鈕即可切換直播場景。

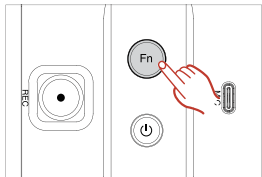

REC 按鈕

• 直播模式：按下按鈕即可開始現場直播。

註記：

需要網路連線和串流傳輸 URL 才能開始現場直播。

• 照片模式：按下按鈕即可拍照。

註記：

需要儲存裝置才能拍照。

• 視訊模式：按下按鈕即可攝影。

註記：

需要儲存裝置才能攝影。

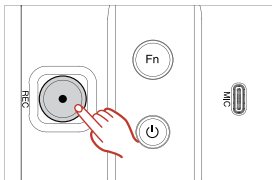

用於連接到 Lark C1 or LARK MAX 無線麥克風的 USB-C 2.0 介面

介面支援連接到 Lark C1 或 LARK MAX 無線麥克風。連接帶有其他 USB-C 介面的音訊裝置時，可能會造成相容性問題。

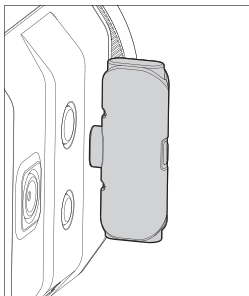

用於進行 UVC 串流傳輸的 USB-C 3.1 介面

介面支援透過 USB 線連接到 PC 以傳輸音訊與視訊串流。

註記：

請使用原廠 USB-C 3.0 線。低於 USB-C 3.0 線可能不支援傳輸您的音訊與視訊串流。

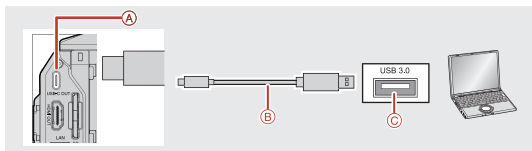

HDMI

HDMI 同螢幕輸出：

當攝影機連接到監視器時，攝影機 UI 可以同步顯示在監視器上進行監控。

HDMI 純內容輸出：

當攝影機連接到廣播電台或監視器時，可以輸出音訊和視訊串流以供串流傳輸。

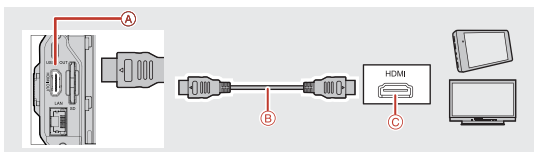

RJ45 介面

介面用於連接到網路並進行串流傳輸。

綠燈：攝影機已妥善連接到網路。

紅燈：攝影機未連接到網路。

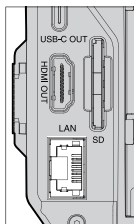

3.5 mm 介面

介面用於連接三段式線路輸入或麥克風輸入裝置。

註記：

當線路輸入或麥克風輸入裝置連接時，請選取對應的模式。否則，可能會導致收音異常甚至收不到音訊。

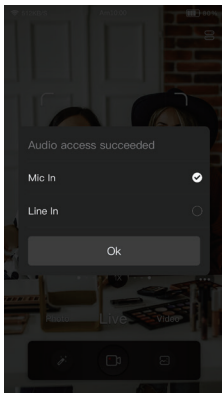
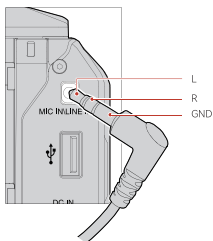

USB-A 介面

介面用於連接到 USB 隨身碟以儲存照片或影片，或用於連接到滑鼠或鍵盤以操作攝影機。

註記：

1. 當攝影機正在傳輸或存取資訊時，請勿拔下 USB 隨身碟。否則，資料可能會遺失或損壞，甚至 USB 隨身碟或攝影機可能會損壞。在更換或拔下 USB 隨身碟之前，請關閉攝影機。無法復原使用損壞的 USB 隨身碟所造成的遺失，包括資料遺失。
2. 攝影時，請使用 10 級以上的 USB 隨身碟儲存影片。影片檔案的最大尺寸為 4GB。

3. 如果提示您沒有使用 USB 隨身碟儲存資料的完整權限，請檢查或更換 USB 隨身碟。



SD 卡插槽

• 插入 SD 卡

插入 SD 卡，直至其卡入到位。請正確插入 SD 卡，以免發生故障。

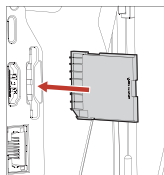

• 取下 SD 卡

輕輕推入 SD 卡一次即可取下。

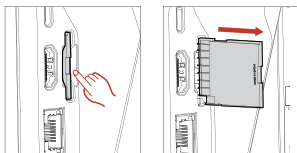

直流電源介面

電源轉接器介面。強烈建議使用原廠轉接器以避免攝影機損壞的風險。

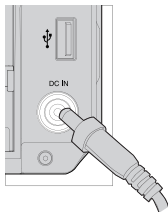

註記：

1. 當攝影機正在傳輸或存取資訊時，請勿取下 SD 卡。否則，資料可能會遺失或損壞，甚至可能損壞 SD 卡或攝影機。在更換或取下 SD 卡之前，請關閉攝影機。無法復原使用損壞的 SD 卡所造成的遺失，包括資料遺失。
2. 攝影時，請使用 10 級以上的 SD 卡來儲存影片。影片檔案的最大尺寸為 4GB。
3. 如果提示您沒有使用 SD 卡儲存資料的完整權限，請檢查或更換 SD 卡。

電池槽

• 安裝電池

將電池觸點與電池槽中的電池連接座對準，並將電池插入電池槽中。

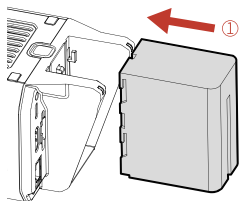

• 取下電池

- ① 按住電池釋放按鈕。
- ② 將電池向上推以將其取下。

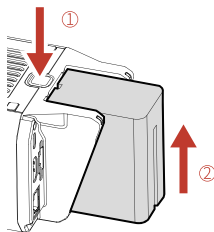
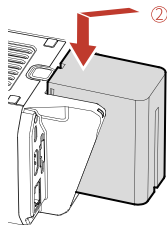

1/4" 螺紋孔

用於水平或垂直安裝攝影機。

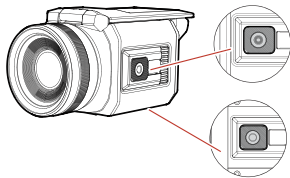

冷靴安裝

用於安裝外部裝置。

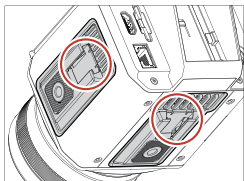

變焦環

- 順時針旋轉變焦環即可縮短焦距。
- 逆時針旋轉變焦環即可增大焦距。

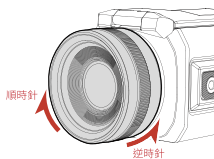

螢幕

- 向上
螢幕只能打開到 180°。小心不要將螢幕進一步打開。
- 向左
螢幕只能打開到 180°。小心不要將螢幕進一步打開。
- 向右
螢幕只能打開到 130°。小心不要將螢幕進一步打開。

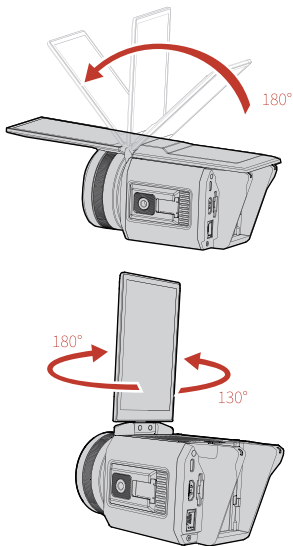

UVC 串流傳輸

1. 透過 USB 線將攝影機連接到電腦。
(註記：電腦上的 USB 介面和 USB 線必須支援 USB-C 3.0 標準。)
2. 在電腦上開啟串流傳輸軟體或現場直播軟體。
3. 選取裝置。
 - 選取 **HOLLYLAND FHD Camera** 作為攝影機。
 - 選取 **HOLLYLAND** 作為音訊裝置。

串流傳輸到直播平台

透過 HDMI 線連接至導播機

1. 透過 HDMI 線將攝影機連接到導播機。
(註記：HDMI 線必須支援 HDMI 1.4 以上版本。)
2. 在顯示的對話方塊中選取 **HDMI Content-Only Output**。
(註記：不建議將 HDMI 同螢幕輸出用於串流傳輸。)
3. 攝影機視訊串流和聲音在導播機上顯示之後，輸入對應的串流傳輸 URL。
(註記：導播機需要連接到網路。)
4. 按導播機上的 **Live** 即可開始串流傳輸。

透過 HDMI 線連接到監視器

1. 透過 HDMI 線將攝影機連接到監視器。
(註記：HDMI 線必須支援 HDMI 1.4 以上版本。)
2. 在顯示的對話方塊中選取 **HDMI Same-Screen Output** 或 **HDMI Content-Only Output**。
3. 監視器上顯示攝影機視訊串流和聲音之後連線成功。

主畫面



導覽



1. 從頂部向下滑動即可進入快速設定介面。
2. 從底部向上滑動即可進入主介面。
3. 向左或向右滑動即可返回前一個介面。

狀態圖示說明

	攝影機正在使用乙太網路。
	攝影機正在使用 Wi-Fi 網路。
	目前沒有網路。
Am 10:00 目前時間。	
	連接到攝影機的音訊裝置為 Lark C1 或 LARK MAX 無線麥克風。
	連接到攝影機的音訊裝置為麥克風輸入裝置。
	連接到攝影機的音訊裝置為線路輸入裝置。
	SD 卡已插入攝影機。
	USB 裝置已插入攝影機。
	UVC 串流傳輸進行中。
	目前只有 USB-C 連接。
	攝影機透過 HDMI 線連接到裝置。
	攝影機藍牙已啟用。
	攝影機由不同於電池的電源供電。
	攝影機由電池供電。

更多設定

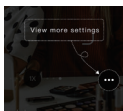

點按  即可檢視更多功能和參數，包括螢幕旋轉、實景和 Pro 參數。

串流傳輸 URL

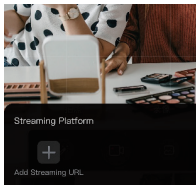

新增串流傳輸 URL 有兩種方式。
方法 1：行動電話掃描 QR 碼，輸入串流傳輸名稱和串流傳輸 URL，然後點按 **Submit**。資訊將同步到攝影機。接著點按攝影機上的 **Finish**。

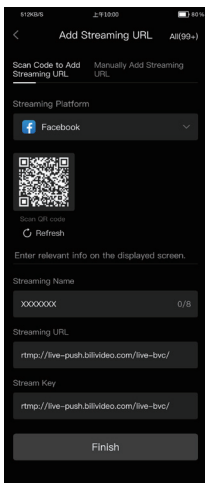

方法 2：點按 **Manually Add Streaming URL**，輸入串流傳輸名稱和串流傳輸 URL，然後點按 **Finish**。

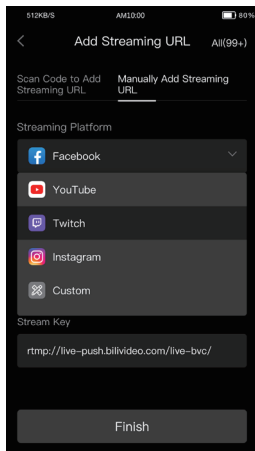

串流傳輸 URL

需要串流傳輸伺服器位址和串流金鑰才能輸入串流傳輸 URL。

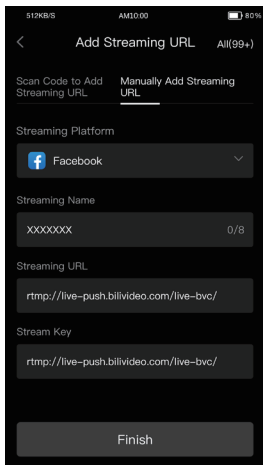

實景

攝影機支援多個實景。

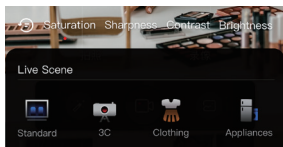

Pro 參數

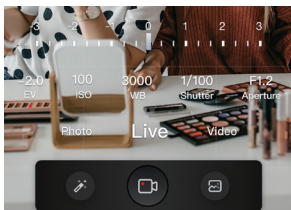

EV 調整曝光補償。

ISO 調整攝影機靈敏度。

WB 調整白平衡。

快門 調整快門速度。

光圈 調整攝影機光圈。

Pro 參數設定

EV

範圍：-3 至 3

調整曝光補償：點按 EV，然後點按或滑動 EV 調整區域。

註記：

當 ISO 或快門處於自動模式時，可以調整 EV。當 ISO 和快門都不處於自動模式時，無法調整 EV。

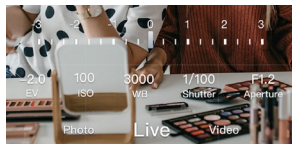

ISO

範圍：100 至 6400

調整攝影機靈敏度：

自動 (A)：攝影機根據環境自動調整靈敏度。

手動：點按 ISO，然後點按或滑動 ISO 調整區域。



WB

範圍：3000 至 7000

調整白平衡：

自動 (A)：攝影機根據環境自動調整白平衡。

手動：根據實際現場直播環境調整白平衡。

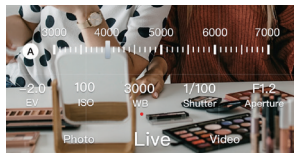

快門

調整快門速度：

點按 Shutter 並選取快門速度。

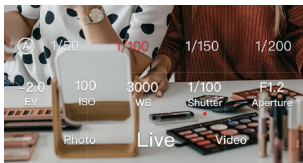

光圈

範圍：F1.2、F1.6、F2.0

調整光圈：

點按 Aperture 並選取光圈值。

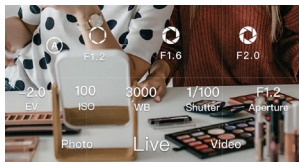

視訊設定

輸入視訊設定：

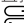
在直播模式或視訊模式下，點按右上角的 。

解析度

調整視訊解析度：

移至  > **HD** 並選取所欲解析度。直播模式下解析度越高，需要的頻寬會越大，且視訊模式下解析度越高，產生的影片檔案會越大。



位元率

調整位元率：

移至  >  並選取所欲位元率。

影片儲存間隔

調整影片儲存間隔：

移至  >  並選取所欲影片儲存間隔。設定僅在視訊模式下生效。

變焦範圍

範圍：1x 至 6x

調整變焦範圍：

方法 1：選取變焦值。



方法 2：雙指縮放即可放大或縮小。

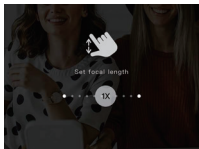

方法 3：旋轉變焦環即可調整焦距。

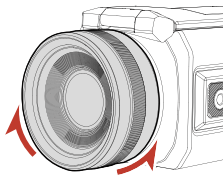

註記：

直播、照片和視訊模式下的焦距相同。

抗條紋顯示

選取適當的頻率選項以避免攝影機在光線下閃爍。

攝影機模式

照片模式

點按拍攝選單即可拍照。

視訊模式

點按拍攝選單即可攝影。

註記：

因為照片和影片只能儲存於外部裝置上，SD 卡或 USB 隨身碟需用於您拍照或攝影時。您可檢視對應的檔案，這些檔案置於照片或檔案。

RTMP 直播模式

點按拍攝選單即可開始現場直播。

註記：

開啟現場直播的先決條件如下：

1. 攝影機已連線至乙太網路或 Wi-Fi 網路。
2. 已新增串流傳輸 URL。

快速設定

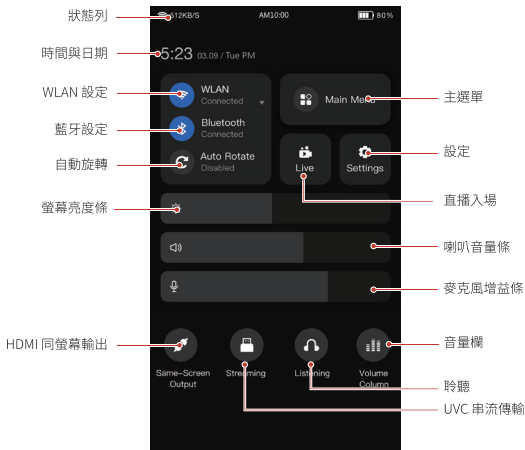

WLAN 設定

點按圖示即可開啟或關閉 WLAN 功能，或按住圖示即可進入 WLAN 介面。

藍牙設定

點按圖示即可開啟或關閉藍牙功能，或按住圖示即可進入藍牙介面。

自動旋轉

點按圖示即可開啟或關閉自動旋轉功能。

螢幕亮度條

移動滑桿即可調整螢幕亮度。

喇叭音量條

移動滑桿即可調整喇叭音量。

麥克風增益條

移動滑桿即可調整麥克風增益。

HDMI 同螢幕輸出

攝影機透過 HDMI 纜線連接到裝置之後，向下滑動即可進入快速設定介面，然後點按 **Same-Screen Output** 圖示。您可以在 **HDMI Same-Screen Output** 與 **HDMI Content-Only Output** 之間切換。

設定

向下滑動即可進入快速設定介面，然後點按 **Settings** 圖示即可進入攝影機設定介面。

直播入場

向下滑動即可進入快速設定介面，然後點按 **Live** 圖示即可進入直播介面。

UVC 串流傳輸

攝影機透過 USB-C 3.0 線連接到裝置之後，向下滑動即可進入快速設定介面，然後點按 **Streaming** 圖示即可進入 UVC 串流傳輸模式。

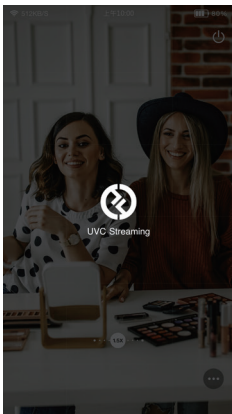

主選單

向下滑動即可進入快速設定介面，然後點按 **Main Menu** 圖示即可進入主選單介面。在主選單介面點按應用程式即可進入應用程式。

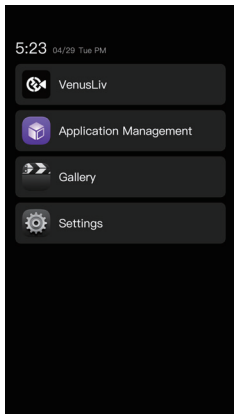

音量欄

向下滑動即可進入快速設定介面，然後點按 **Volume Column** 圖示即可將功能開啟或關閉。您可以在直播模式或視訊模式下監控音訊增益。

聆聽

向下滑動即可進入快速設定介面，然後點按 **Listening** 圖示即可進入聆聽模式。

設定

連線至 WLAN

1. 移至 **Settings > WLAN** 並開啟 **WLAN** 功能。
2. 在 **WLAN** 設定介面上，從可用 **WLAN** 清單選擇要連線的 **WLAN**。如果選取加密網路，則需要密碼。

刪除 WLAN

1. 移至 **Settings > WLAN** 並開啟 **WLAN** 功能。
2. 在已連線的 **WLAN** 清單中按住要刪除的 **WLAN**，然後點按 **Delete**。

有線網路

移至 **Settings > Wired Network**，然後開啟或關閉有線網路功能。
有線網路功能預設開啟。當網路線插入攝影機時，攝影機會自動連線至網路。

手動輸入 IP 位址

Settings > Wired Network，關閉 **Obtain IP Address Automatically** 功能，輸入所欲 **IP** 位址、子網路遮罩和預設閘道器，然後點按 **Save**。如果開啟 **Obtain IP Address Automatically** 功能，預設會自動取得 **IP** 位址、子網路遮罩和預設閘道器。

手動輸入 DNS 伺服器位址

移至 **Settings > Wired Network**，關閉 **Obtain DNS Server Address Automatically** 功能，輸入所欲首選 **DNS** 伺服器位址和備用 **DNS** 伺服器位址，然後點按 **Save**。如果開啟 **Obtain DNS Server Address Automatically** 功能，則預設會自動取得首選 **DNS** 伺服器位址和備用 **DNS** 伺服器位址。

藍牙

進入 移至 **Settings > Bluetooth**，並開啟或關閉藍牙功能。

變更裝置藍牙名稱：

1. 移至 **Settings > Bluetooth** 並開啟藍牙功能。
2. 點按裝置藍牙名稱，輸入新名稱，然後點按 **OK**。

連線至藍牙裝置：

1. 開啟藍牙裝置並確保其可被發現。
2. 移至 **Settings > Bluetooth** 並開啟藍牙功能。接著，攝影機會自動搜尋可用藍牙裝置。
3. 在可用藍牙裝置清單中選擇要連線的裝置，並根據提示完成配對。

與藍牙裝置中斷連線：

1. 移至 **Settings > Bluetooth** 並開啟藍牙功能。
2. 在已連線藍牙裝置清單中按住要中斷連線的藍牙裝置，然後點按 **Delete**。

應用程式管理

- **開啟應用程式**
移至 **Settings > App Management**，點按要開啟的應用程式。
- **更新應用程式**
移至 **Settings > App Management**，點按要更新的應用程式。

音量與亮度調整

移至 **Settings > Sound & Brightness** 即可調整螢幕亮度和音量。

- **調整螢幕亮度**
移動螢幕亮度條上的滑桿即可調整螢幕亮度。
- **調整音量**
移動喇叭音量條上的滑桿即可調整喇叭音量。
移動麥克風增益條上的滑桿即可調整麥克風增益。

儲存

- **清除攝影機快取**
移至 **Settings > Storage** 並點按 **Clear** 即可清除攝影機快取。
- **刪除應用程式資料**
移至 **Settings > Storage**，點按應用程式即可進入應用程式管理介面，然後點按 **Delete Data**。
- **清除應用程式快取**
移至 **Settings > Storage**，點按應用進入應用管理介面，然後點按 **Clear Cache**。
- **記憶體**
已安裝系統和軟體會佔用一些記憶體。

檔案管理

您可以檢視儲存裝置上的照片和影片。

系統與更新

系統升級

當有新版本發佈時，攝影機會提示您下載並安裝最新韌體以升級系統。

註記：

使電源轉接器保持連接到攝影機，並且在升級期間請勿切斷電源。如果升級失敗且攝影機無法使用，請聯絡我們的售後人員。

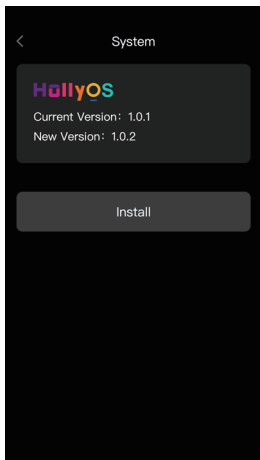

語言

移至 **Settings > System & Update > Language** 選取所欲語言。

還原預設設定

移至 **Settings > System & Update > Restore**，點按 **Reset Camera**，然後根據提示重設攝影機。

註記：

此操作會將資料從攝影機的內部儲存空間刪除（包括帳戶資訊、系統與應用程式資料以及系統設定）。請先備份資料再進行此操作，以免資料遺失。

關於攝影機

您可以檢視攝影機的基本資訊和法律資訊。

照片

照片介面

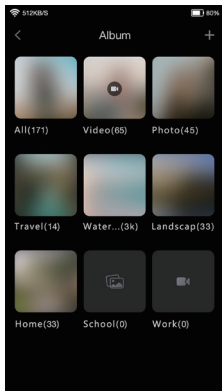

檔案詳細資訊

您可以點按照片或影片並且全螢幕觀看。您也可以再次點按螢幕以隱藏選單。全螢幕觀看照片或影片時，您可點按 **i** 以在顯示的快顯選單中檢視諸如照片或影片的儲存路徑、解析度和大小等參數資訊。

移動照片與影片

1. 點按要移動的照片或影片。
2. 點按 **Move** 並選取要將照片或影片移動過去的相簿或建立該相簿。
3. 檔案移動之後，將不再儲存於原本的相簿中。

重新命名照片與影片

1. 點按要重新命名的照片或影片。
2. 點按 **Rename** 並輸入新名稱。
3. 點按 **OK**。

刪除照片與影片

點按要刪除的照片或影片（按住檔案即可選取多個檔案），點按 **Delete**，然後點按 **OK**。

註記：

已刪除照片或影片無法還原。

建立相簿

1. 移至照片並進入相簿介面。
2. 點按 **+**，輸入新相簿名稱，然後點按 **OK**。
3. 選取要新增到新相簿的照片或影片，然後將其移動到相簿。

對照片與影片進行排序

移至照片，進入相簿介面，然後點按右上角的 **i** 以開始排序。支援按建立時間、檔案名稱或檔案大小升序或降序排序。

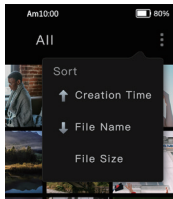

狀態指示燈



網路指示燈：紅 / 綠 ■ ■

- 長亮綠燈：網路連線成功
- 長亮紅燈：網路連線異常
- 熄滅：攝影機正在初始化

操作指示燈：紅 / 綠 ■ ■

- 長亮綠燈：操作正常
- 綠燈緩慢閃爍：攝影機正在初始化
- 長亮紅燈：攝影機狀態異常
範例：檔案儲存空間異常或已滿，電池電量低等。
- 紅燈緩慢閃爍：韌體升級進行中

直流電源指示燈：黃 ■

- 黃燈亮起：攝影機連接到直流電源轉接器。
- 黃燈熄滅：攝影機由電池供電 / 攝影機開啟。

規格

CPU	Qualcomm	
CMOS	Sony	
OS	HollyOS	
重量	900 g (31.7 oz)	
尺寸	(LxWxH) : 178 mm x 99.7 mm x 94.8 mm (7" x 3.9" x 3.7")	
功耗	< 12 W	
輸入電壓	12 V DC	
無線技術	Wi-Fi : 2.4 GHz + 5 GHz	藍牙 5.0
操作溫度	-10° C 至 40° C	
FOV	80° (水平) /46° (垂直)	
變焦	3倍光學變焦*2倍數碼變焦	
對焦	自動混合對焦	
觸控螢幕	5" LCD	1080 x 1920 像素
外部電池	NP-F 電池	
介面	直流輸入	帶有螺紋鎖的直流介面
	麥克風輸入 / 線路輸入	3.5 mm
	HDMI 輸出	Type A@HDMI 1.4
	SD 卡插槽	SDIO3.0 @SDXC
	USB-C 輸出	USB-C 3.1
	麥克風	用於連接到 Lark C1 或 LARK MAX 無線麥克風的 USB-C 2.0。
	USB-A	USB 2.0
	RJ45	1.0 Gbps

攝影機安全性

警告：

如果您未能遵循以下注意事項，則可能會因觸電或火災而重傷或死亡，或者您的 VenusLiv 可能會損壞。使用前請檢查攝影機及配件是否完好。基於安全原因，只能使用攝影機隨附的 Hollyland 配件或購買的正版配件。使用非 Hollyland 推薦的任何其他零件、配件或充電器可能會導致火災、觸電或人身傷害。使用未經授權的配件所造成的損壞不在保固範圍內。有關核准的配件，請造訪 Hollyland 官方網站，網址為：<https://www.hollyland.com>。

1. 將攝影機連接到轉接器時，請勿用濕手觸碰插頭或轉接器。不遵循此注意事項可能會導致觸電。
2. 請勿將攝影機放置或固定在不穩固的表面上。不遵循此注意事項可能會導致攝影機鬆動或掉落，從而導致事故或損壞攝影機。
3. 使用外部電源供應連接時，請遵循第三方電源供應裝置的所有安全規則。
4. VenusLiv 的鏡頭由玻璃製成。如果鏡頭損壞，請小心處理以免被破碎的鏡頭 / 玻璃刮傷，並且請遠離兒童。
5. 攝影機的溫度可能會在操作期間升高。如果發生這種情況，請關閉攝影機並使其先冷卻再使用。
6. 本產品不是玩具，您應完全負責遵守所有當地法律、規範和限制。
7. 請勿使用 VenusLiv 進行未經授權的監控、偷拍或採取任何違反個人隱私規範的作法。正常狀況下，嚴禁將攝影機用於此類目的。如果您未遵循此注意事項，則可能會承擔巨大責任並面臨刑事訴訟。
8. 請勿將攝影機置於極冷或極熱的環境中。
極冷或極熱的環境可能會導致攝影機暫時停止妥善運作。

註記：







VenusLiv 的鏡頭沒有保護措施。如果不注意，很容易造成刮痕。請將 VenusLiv 存放在隨附的盒子中，並且避免將鏡頭放在任何表面上。鏡頭刮痕不在保固範圍內。

免責聲明

1. 請仔細閱讀並遵守所有說明。
2. 請注意所有警告。
3. 產品請勿在諸如輻射器、電暖器、火爐或其他發熱裝置等熱源附近使用。
4. 僅使用 Hollyland 指定或提供的零件和配件。
5. 請將所有維護工作交給合格人員。無論產品遭受何種損壞，諸如電源線或插頭損壞、液體滲入、物體掉入產品、雨淋、受潮、無法正常運作、或掉落，都需要維護。

支援

如果您在使用產品時遇到任何問題，或需要任何幫助，請透過以下方式聯絡 Hollyland 支援團隊：

-  Hollyland User Group
-  HollylandTech
-  HollylandTech
-  HollylandTech
-  support@hollyland.com
-  www.hollyland.com

聲明

版權歸深圳市昊一源科技有限公司所有。未經深圳市昊一源科技有限公司書面許可，任何組織和個人不可複製或轉載任何文字或圖解內容之部分或全部，也不可以任何形式傳播。

商標聲明

所有商標均歸深圳市昊一源科技有限公司所有。

註記：

由於產品版本升級或其他原因，本使用者手冊將不定期更新。除非另有協議，本文件僅作為使用指南提供。本文件中的所有陳述、資訊、建議不構成任何明示或暗示的保證。

FCC 要求

任何未經合規責任方明確核准的變更或修改都可能導致使用者操作設備的權限失效。本裝置符合 FCC 規定的第 15 部分。操作需滿足以下兩個條件：(1) 本裝置可能不會造成有害干擾，以及 (2) 本裝置必須接受任何收到的干擾，包括可能造成非所欲操作的干擾。

FCC 輻射曝露聲明：

裝置已經過測試並發現符合 FCC SAR 限制。

註記：

根據 FCC 規定第 15 部分，本設備已經過測試並符合 Class B 數位裝置的限制。這些限制旨在提供合理的保護，防止住宅安裝中的有害干擾。本設備會產生、使用並輻射射頻能量，如果不按照指示安裝和使用，可能會對無線電通訊造成有害干擾。然而，不保證特定安裝不會發生干擾。如果此設備確實對無線電或電視接收造成有害干擾，（可透過關閉和開啟設備來判定），建議使用者嘗試透過以下一項或多項措施來校正干擾：

- 重新調整接收天線的方位或位置。
- 增加設備與接收器之間的間隔。
- 將設備連接到與接收器所接電路迴路以外的插座。
- 請洽詢經銷商或有經驗的無線電 /TV 技術人員尋求協助。

