



Pyro Ultra

User Manual

V0.1

Preface

Thank you for choosing the Pyro Ultra Wireless High-Definition Video Transmission System. This product features the latest image encoding and decoding technology, combined with dual-band (5G & 2.4G) wireless transmission technology, enabling ultra-low latency video transmission.



Scan the QR code to access the full user manual on our website.

Key Features

Key Features

Core Technology Strength

- **Proprietary TWiFi Transmission Technology:** Supports one-to-many transmission from a single transmitter to an unlimited number of receivers in Broadcast Mode (optimal performance with up to 20 receivers). An integrated dynamic frequency management system automatically scans and selects the best available channels at startup, enabling automatic frequency hopping for strong interference resistance. Signal transmission remains stable and reliable even in complex environments.

Transmission Performance

- **Ultra-low Latency Transmission:** Achieves ultra-low latency of 20ms for 1080p25 signals in interference-free environments, meeting the demands of professional real-time monitoring.
- **Ultra-long Transmission Range:** In non-broadcast mode, supports up to 4,900 ft (1.5 km) line-of-sight wireless transmission (in open environments). Seamless cross-system coordination is available when paired with our Pyro-series devices.

Full HD Compatibility

- **Multi-interface UHD Support:**
 - HDMI Port: Supports 4K60 ultra-high-definition video transmission.
 - SDI Port: Supports stable 1080p high-definition signal transmission, compatible with broadcast equipment.
- **Flexible Streaming Solutions:** The receiver supports 4K60 UVC plug-and-play streaming and 1080p RTMP protocol streaming, ensuring instant compatibility with mainstream live streaming platforms.

Professional Adaptability

- **Dynamic Frequency Selection Certification:** Certified for DFS (Dynamic Frequency Selection), automatically avoids radar frequency interference and complies with worldwide spectrum regulations.
- **Multiple Power Supply Options:** Supports a locking DC power input, NP-F lithium batteries, a clip-on V-mount battery plate, and an optional V-mount battery interface, providing reliable power solutions for both mobile outdoor operation and fixed installation scenarios.
- **Ecosystem Compatibility**
- **Seamless Pyro-series Integration:** In non-broadcast mode, fully compatible with Pyro-series devices, enabling system-level collaborative operation across ecosystem devices and building a flexible, scalable wireless transmission matrix.
- * **Note:** All specifications are based on official Hollyland laboratory test data

Package Contents

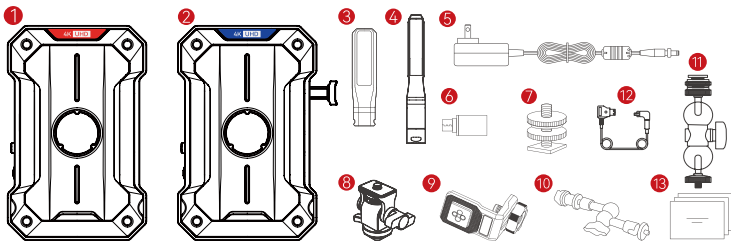

SKU Package Options	1TX & 1RX	1TX & 2RX	1TX	1RX
① Transmitter	1	1	1	-
② Receiver	1	2	-	1
③ Easy-Install Short Antenna	4	4	4	4
④ Easy-Install Antenna	4	8	-	-
⑤ DC Power Adapter 12V/2A	1	1	-	1
⑥ OTG Adapter	1	1	1	1
⑦ Cold Shoe	-	-	1	-
⑧ Rotatable Cold Shoe Mount	-	-	-	-
⑨ Screw Fitting for Stabilizer	-	-	-	-
⑩ Magic Arm	-	-	-	-
⑪ Double Ball Head with Cold Shoe Mount	1	1	-	-
⑫ D-Tap to Locking DC Power Cable	1	1	-	-
⑬ Quick Guide & Packing List Card & Warranty Card	1	1	1	1

Note: 1. The quantity and appearance of accessories may vary depending on the purchased package configuration. Please refer to the actual packing list included with your purchase.

2. Items ③, ④, ⑤, ⑧, ⑨ and ⑩ are available for optional purchase on Hollyland official website if needed.

System Connection

■ Non-broadcast: 1TX & 4RXs + 2 APPs

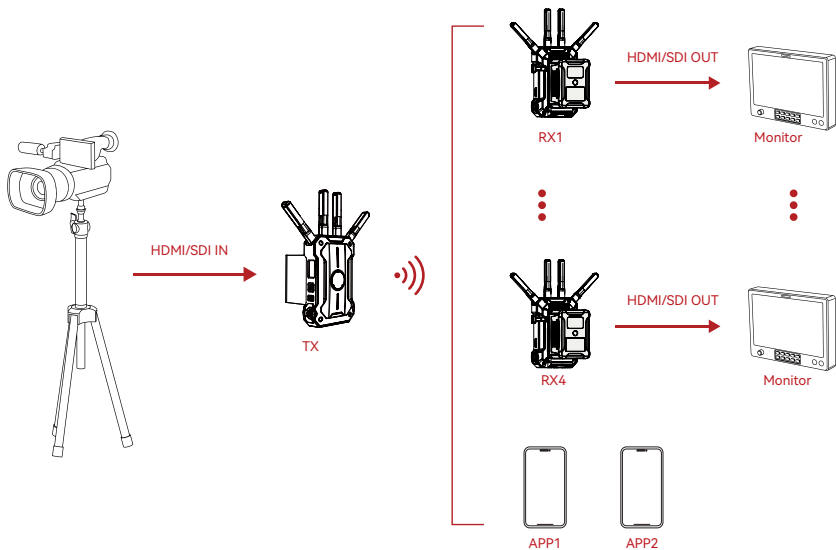

System Connection

■ Broadcast: 1TX & Unlimited RXs

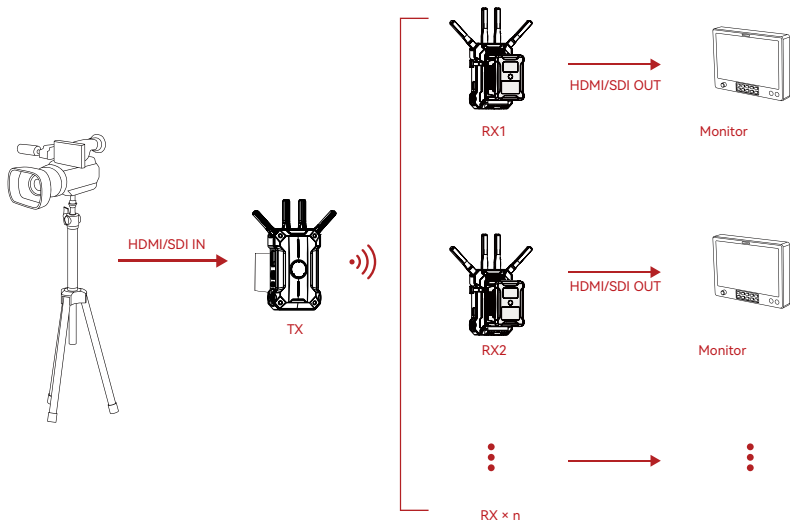

Ports & Controls

Transmitter

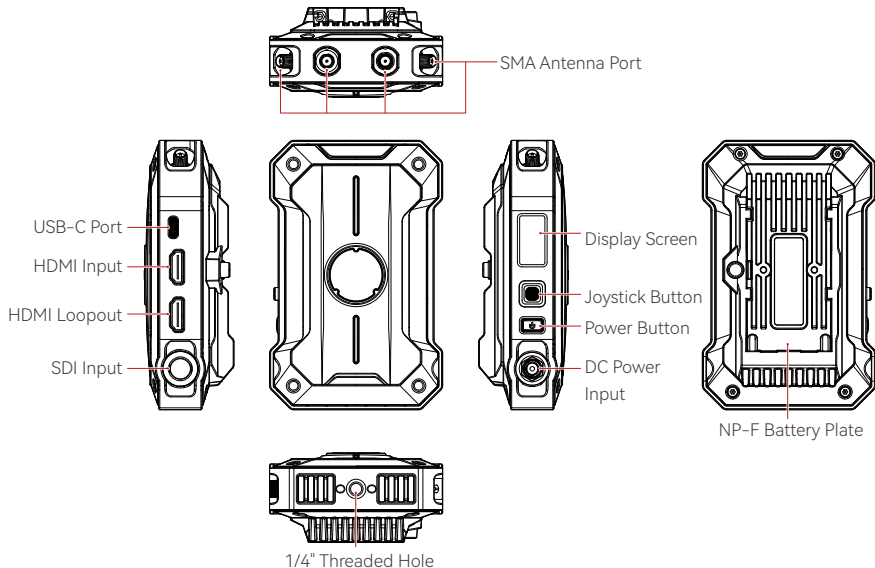

Ports & Controls

Receiver

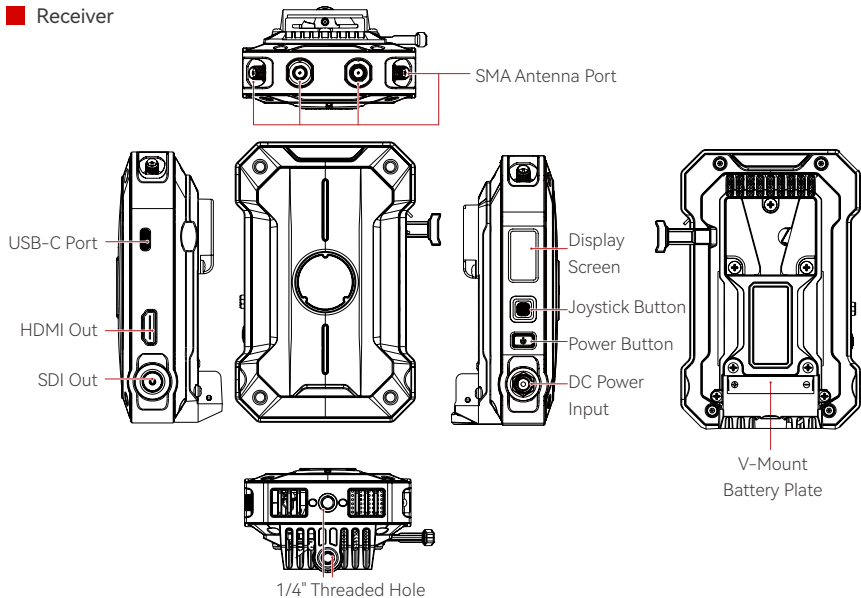

Product Installation

Transmitter Installation

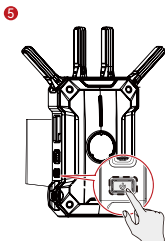
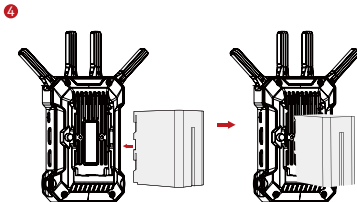
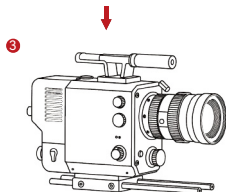
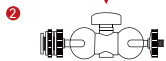
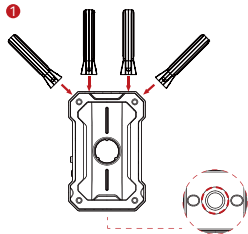

1. Install the antennas according to the indicated orientation.
2. Mount the transmitter to the camera using the double ball head with cold shoe mount.
3. Connect the transmitter to the camera via HDMI or SDI cables.
4. Install the battery (compatible with NP-F970 or equivalent series batteries).
5. Press the power button to turn on the device.

Product Installation

Receiver Installation

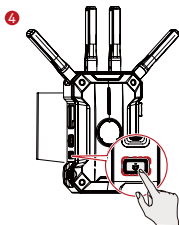
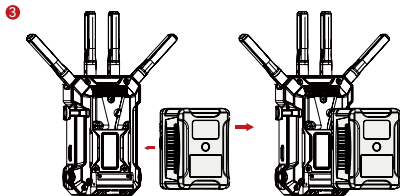
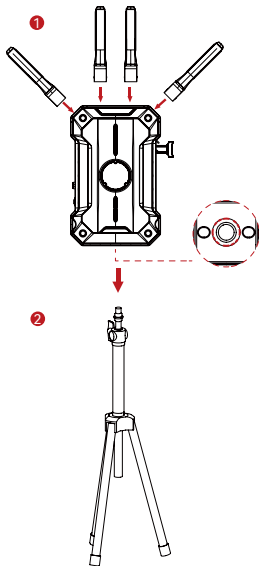

1. Install the antennas according to the indicated orientation.
2. Mount the receiver to the stand using the 1/4" threaded hole at the bottom.
3. Install the battery (compatible with NP-F970 or equivalent series batteries).
4. Press the power button to turn on the device.

Quick Start

Entering the Menu

Press and hold the joystick button for 3 seconds to enter the menu interface. Move the joystick up or down to navigate through the menu options. Press the joystick button to confirm the selection.

Page Details

■ Transmitter Home Page

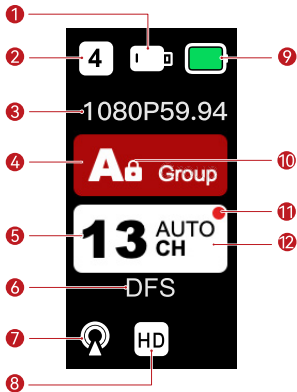

Transmitter Home Page	
① USB-C Connection	⑥ DFS
② Receiver Connection Count	⑦ Broadcast Mode
③ Resolution	⑧ HD Mode
④ Current Group	⑨ Battery Level
⑤ Current Channel	⑪ Channel Status
⑩ Press and hold the Joystick Button upward to activate group lock. Once enabled, other receivers will no longer be able to join this group	
⑫ Move the Joystick Button up or down to select "AUTO" to enable seamless auto frequency hopping	

Quick Start

Receiver Home Page

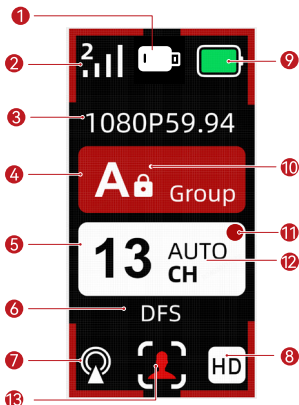

Receiver Home Page	
① USB-C Connection	⑦ Broadcast Mode
② Camera No. & Signal	⑧ HD Mode
③ Resolution	⑨ Battery Level
④ Current Group	⑩ Channel Status
⑤ Current Channel	⑬ Focus Mode
⑥ DFS	
⑩ Press and hold the Joystick Button upward to activate group lock. Once enabled, other receivers will no longer be able to join this group	
⑫ Move the Joystick Button up or down to select "AUTO" to enable seamless auto frequency hopping	

Quick Start

Function Overview

Transmitter Function Overview



Scene Mode

Provides optimized presets based on different shooting scenarios



Group Pairing

Transmitters and receivers in the same group will automatically pair



Fan Settings

Selects different fan modes to meet heat dissipation needs



Broadcast Mode

When enabled, one transmitter can connect to unlimited receivers. Optimal performance is achieved with up to 20 receivers



System Settings

Views device-related information and configures settings



Back



HD Mode

Fixed at 8~12 Mbps bitrate



Smooth Mode

Extends transmission range while maintaining latency as low as 22ms



Freeze Frame

When enabled, the receiver will display the last transmitted frame if the signal is interrupted



Language

Switches the language between Chinese and English



Network Info

Views WiFi name (SSID) and password



Version Info

Views system version information



Reset

Resets to default settings

Quick Start

Function Overview

Receiver Function Overview



Frequency Scan

Displays the signal quality of available channels. Allows the user to select the optimal channel or activate automatic frequency hopping



Group Pairing

Transmitters and receivers in the same group will automatically pair



Language

Switch the language between Chinese and English



Fan Settings

Selects different fan modes to meet heat dissipation needs



Network Info

Views WiFi name (SSID) and password



Focus Mode

Only one receiver within a group can have Focus Mode enabled at a time. When enabled, transmission latency can be as low as 22 ms, depending on the environment. Other receivers in the same group will keep the same



System Settings

Views device-related information and configures settings



Version Info

Views system version information



Back



Reset

Resets to default settings

Quick Start

Receiver Streaming Overview

■ RTMP Streaming

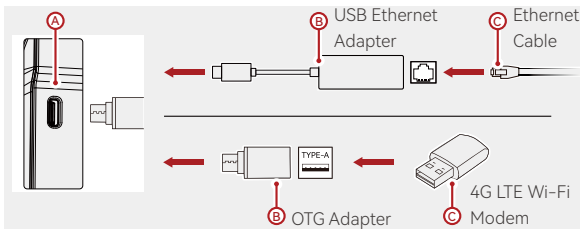

Operation Steps:

1. Connect the receiver to a data-enabled 4G LTE Wi-Fi Modem or a wired Ethernet connection using the OTG adapter;
2. Check the USB-C port indicator for connection status:

Network Status:



Streaming Status:



Streaming Interrupted:



3. Enter the streaming URL via the HollyView app, then start streaming.

Quick Start

UVC Streaming

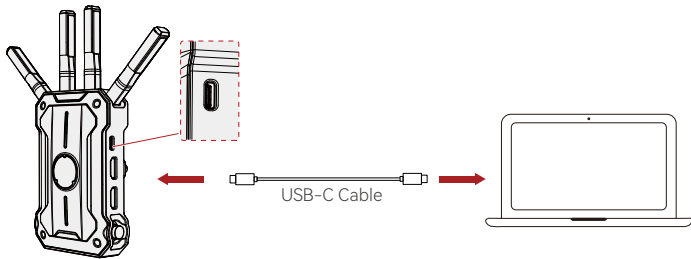

Operation Steps:

1. Connect the receiver (already receiving video signals) to the computer via a USB-C cable;
2. Open your streaming software (e.g., OBS) and check if a new video source has been added;
3. Select the video source and start streaming.

Quick Start

■ APP Installation and Connection

1. HollyView APP Download



2. APP Connection Guide

On your mobile device, go to WiFi settings and select the device WiFi network (SSID: HLD + Device ID). Enter the WiFi password or scan the QR code on the transmitter body using the APP to establish connection. (Default password: 12345678. If the WiFi password has been changed, QR code scanning will not work). Once connected, open the APP to start video monitoring.

Product Specifications

	Transmitter	Receiver
Model	Pyro Ultra	
Product Name	Wireless Video Transmission System	
Interfaces	DC IN: 2.0 Barrel Connector HDMI IN: HDMI 2.0 HDMI LOOPOUT: HDMI 2.0 SDI IN: 3G SDI Type-C: USB 2.0 Antenna: SMA Male Connector	DC IN: 2.0 Barrel Connector HDMI OUT: HDMI 2.0 SDI OUT: 3G SDI Type-C: USB 3.0 Antenna: SMA Male Connector
Power Supply Voltage Range	Battery Power Input: 6.8-8.4V DC Power Input: 6-16V	
Power Consumption	Non-broadcast: 11W Broadcast: 14W	7W
Net Weight	320g	
Dimensions	(L*W*H): 124.5*80*34.9mm	
TX Power	< 23dBm	/
RX Sensitivity	/	Non-broadcast: -85dBm; Broadcast: -80dBm

Product Specifications

	Transmitter	Receiver
Input/Output Video Formats	<ul style="list-style-type: none"> • HDMI: 720p50/59.94/60 1080p23.98/24/25/29.97/30 1080p50/59.94/60 4k(3840*2160)23.98/24/25/29.97/30 4k(3840*2160)50/59.94/60 • SDI: 720p50/59.94/60 1080i50/59.94/60 1080p23.98/24/25/29.97/30 1080p50/59.94/60 	<ul style="list-style-type: none"> • HDMI: 720p50/59.94/60 1080p23.98/24/25/29.97/30 1080p50/59.94/60 4k(3840*2160)23.98/24/25/29.97/30 4k(3840*2160)50/59.94/60 • SDI: 720p50/59.94/60 1080i50/59.94/60 1080p23.98/24/25/29.97/30 1080p50/60
Operating Frequency	5G 5.150 - 5.250 GHz 5.250 - 5.350 GHz 5.725 - 5.850 GHz	2.4G 2.412 - 2.484 GHz
Transmission Latency	Focus Mode: 1080p25 ≥ 20ms	
Bandwidth	20 MHz (Broadcast Mode: 40 MHz)	

*Note: The product's operating frequency and wireless transmission power may vary depending on the regulations of different countries and regions. Please refer to local laws and regulations for details.

Support



Hollyland User Group



HollylandTech



HollylandTech



HollylandTech



support@hollyland.com



www.hollyland.com

HOLLYVIEW

Powered by Hollyland

Manufacturer: Shenzhen Hollyland Technology Co., Ltd.
Address: 8F, 5D Building, Skyworth Innovation Valley, Tangtou
Road, Shiyan Street, Baoan District, Shenzhen, 518108, China
MADE IN CHINA