

VenusLiv Air

Quick Guide

V1.0.0

Foreword

Thank you for purchasing the Hollyland VenusLiv Air camera. Please read this Quick Guide carefully before using the product.

[EN] Please read this Quick Guide carefully. We wish you a pleasant experience. To obtain Quick Guide information in other languages, please scan the QR code below.

[DE] Bitte lesen Sie diese Kurzanleitung gründlich. Wir wünschen Ihnen ein angenehmes Erlebnis. Für die Kurzanleitung in einer anderen Sprache scannen Sie bitte den folgenden QR-Code.

[ES] Lea atentamente esta Guía rápida. Le deseamos una agradable experiencia. Para obtener información de la Guía rápida en otros idiomas, escanee el código QR que aparece a continuación.

[FR] Veuillez lire attentivement ce guide rapide. Nous espérons que votre expérience sera des plus agréables. Pour obtenir des informations sur le guide rapide dans d'autres langues, veuillez scanner le code QR ci-dessous.

[IT] Leggi questa Guida introduttiva rapida. Ti auguriamo un'esperienza piacevole. Per ottenere informazioni sulla Guida introduttiva rapida in altre lingue, scansiona il codice QR qui sotto.

[PT] Leia este Guia Rápido com cuidado. Desejamos que você tenha uma experiência agradável. Para obter informações do Guia Rápido em outros idiomas, digitalize o código QR abaixo.

[TC] 請仔細閱讀本快速指南。我們祝您體驗愉快。若要取得其他語言的快速指南資訊，請掃描下面的 QR 碼。

[KR] 이 빠른 가이드를 주의 깊게 읽으십시오. 즐거운 경험 되시길 바랍니다. 빠른 가이드 정보를 다른 언어로 알아보려면 아래 QR 코드를 스캔하십시오.

[JP] クイックガイドを熟読してください。ご体験をお楽しみください。他の言語でクイックガイド情報を取得するには、以下のQRコードをスキャンしてください。



App Information

HollyCam (Mobile App)

HollyCam is the dedicated mobile app designed for Hollyland live streaming cameras. It allows you to monitor the live view remotely and control your camera wirelessly, making it easier than ever to manage your live stream from anywhere.



HollyStudio (PC Software)

HollyStudio is the official PC software for Hollyland live streaming cameras. In addition to basic camera parameter control, it offers a suite of professional features, including: green screen, image overlays, skin beauty, image import and management. These tools empower you to create high-quality, professional-grade live streaming content with ease.



Packing List

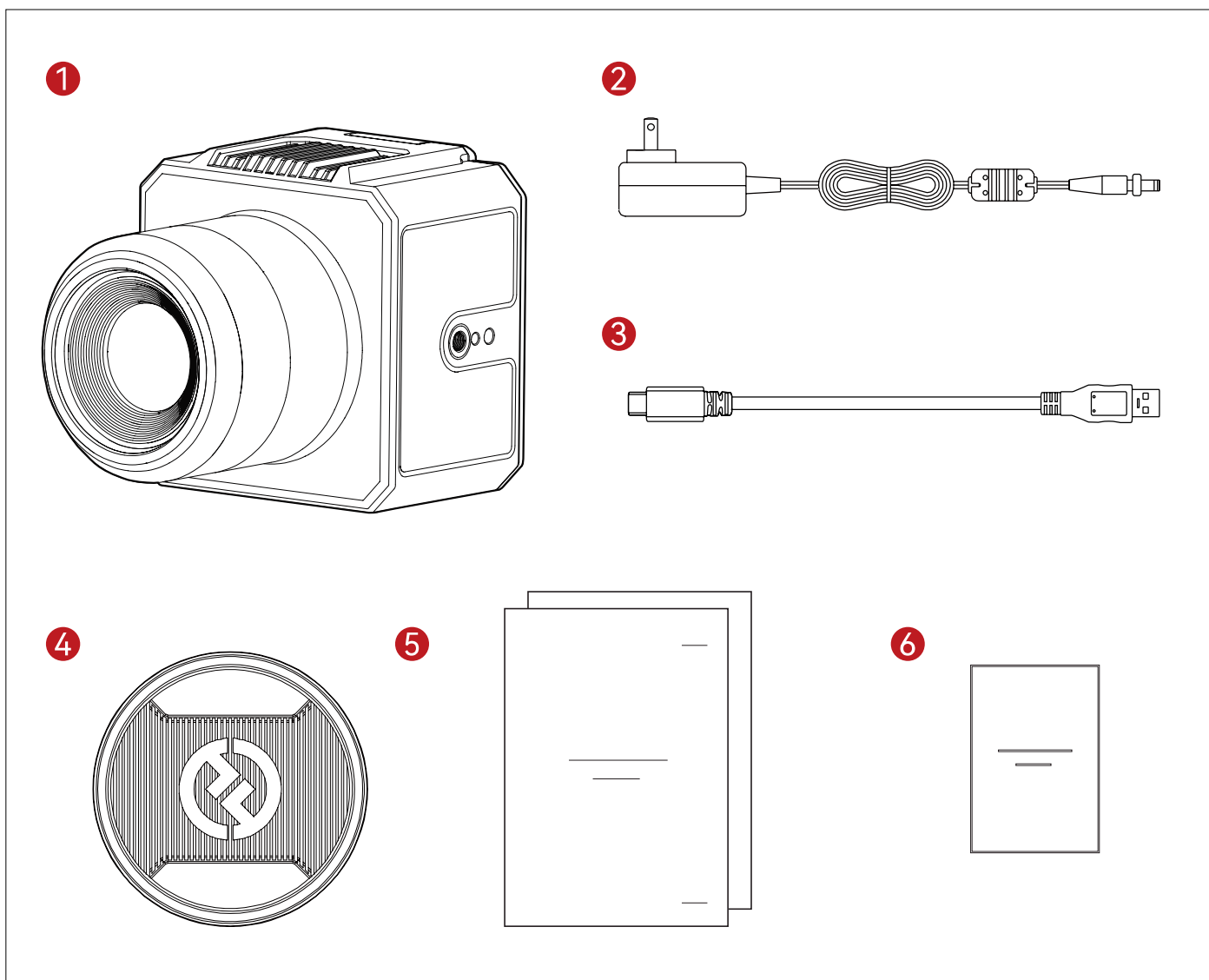

| SKU Configuration | Quantity |
|---|----------|
| ① VenusLiv Air | 1 |
| ② 12V / 2A Power Adapter | 1 |
| ③ USB-C to USB-A Cable (10FT/3M) | 1 |
| ④ Lens Cap | 1 |
| ⑤ Quick Guide & Compliance Information Card | 1 |
| ⑥ Warranty Card | 1 |

Note: Quantity is related to configuration and is based on the actual list of equipment purchased.

Product Overview

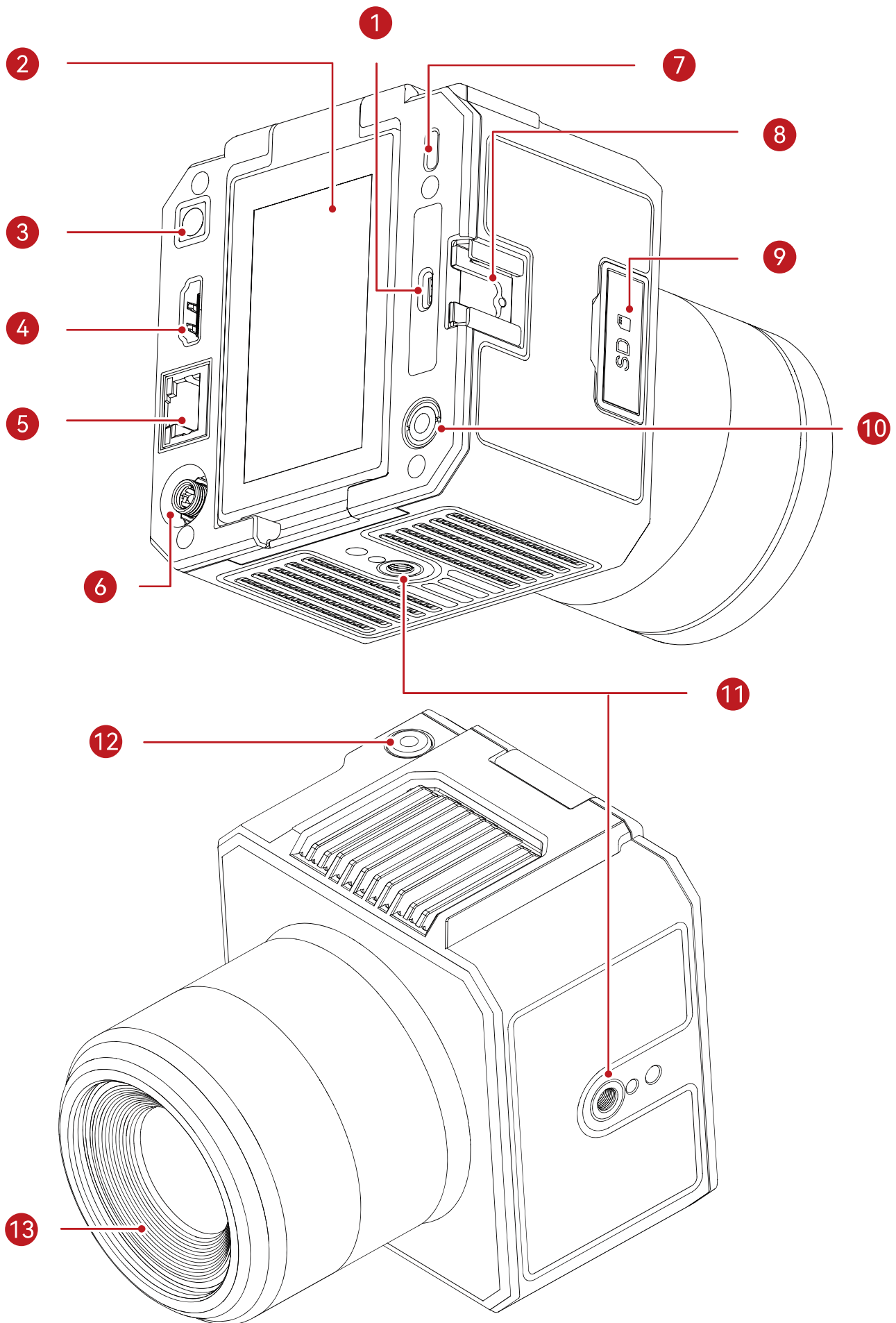

Product Overview

| Number | Function Instruction |
|--------|---|
| 1 | Digital Audio Interface Wireless microphone input (only supports the Hollyland Lark series microphones). |
| 2 | Touchscreen Supports swipe down, swipe up, swipe left/right to go back, and tap operations. |
| 3 | Power Button <ul style="list-style-type: none">• Short press to power on, long press (3s) to display the shutdown menu. Status Indicator (Red, Green) <ul style="list-style-type: none">• Solid green: Normal status• Slowly flashing green: Camera in initialization• Solid red: Camera in abnormal status (e.g., storage failure)• Slowly flashing red: Firmware upgrading |
| 4 | HDMI Output For connection to TV, capture card, switcher, etc. <ul style="list-style-type: none">• Extend mode: Outputs only the audio and video streams (without UI interface) |
| 5 | Ethernet Port For network connection. |
| 6 | DC Input For power supply. Use the provided power adapter to avoid damage to the camera. |
| 7 | USB-C Port (for UVC) Connect the camera to a computer using a USB 3.0 cable. <ul style="list-style-type: none">• Using a cable lower than USB 3.0 may result in video display issues. |

Product Overview

| Number | Function Instruction |
|--------|---|
| 8 | Cold Shoe Mount For mounting external devices with a standard camera cold shoe interface. |
| 9 | SD Slot For inserting a standard SD card. <ul style="list-style-type: none">• Please use a SD card with a read / write speed rating of Class 10 or V10 or higher. |
| 10 | 3.5mm Jack For connection to TRS microphones or line-in devices. |
| 11 | 1/4" Threaded Hole For securing the camera. Use a tripod to secure the camera via the 1/4" threaded hole with two mounting methods: vertical and horizontal. |
| 12 | REC Button Press once to record videos or take photos. |
| 13 | Lens 4K optical lens |

Camera Usage

Connect Power

- Use the provided 12V / 2A power adapter to connect the camera as shown in the diagram.

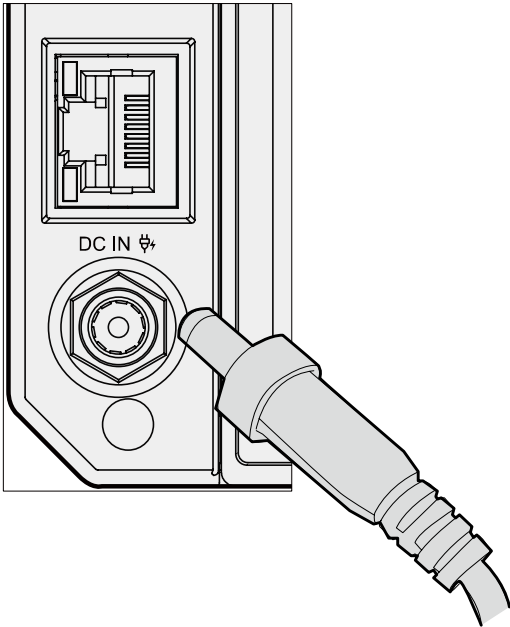

Power on the Camera

- Short press to power on, long press (3s) to display the shutdown menu.

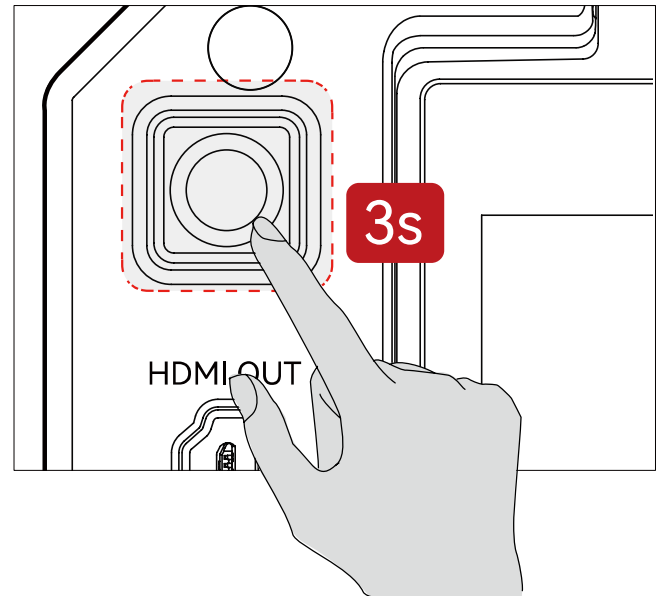

Connect to Computer

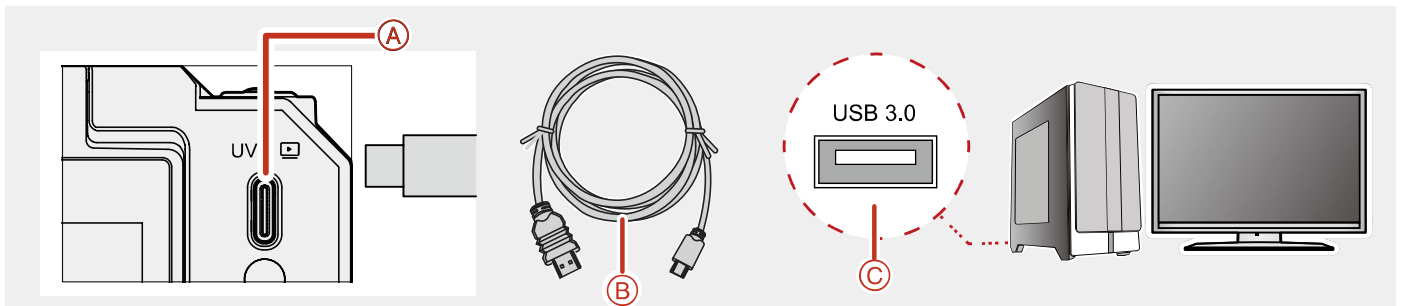

*Note: Please use the supplied USB 3.0 cable. Using a cable with lower specifications may result in abnormal video output.

Connect the Camera to the Monitor via HDMI Cable

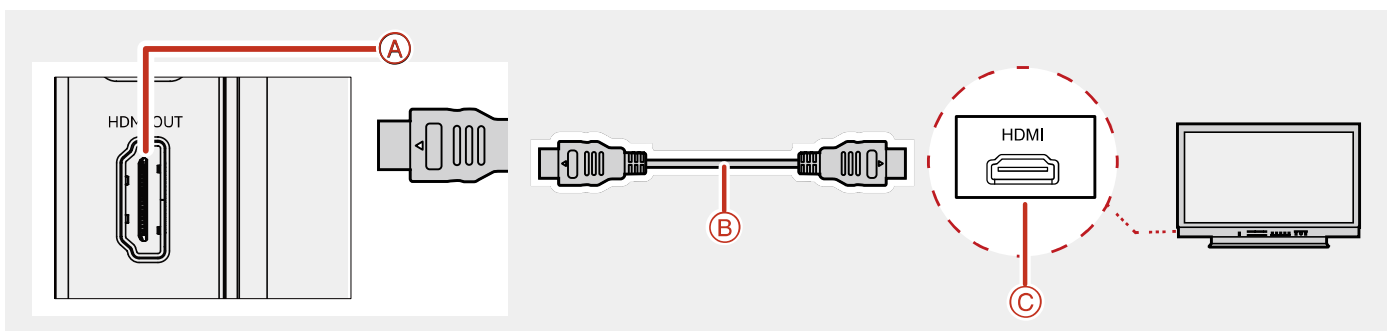

Accessory Usage

Attach to Tripod

1. Open the tripod plate clip and remove the quick-release plate.

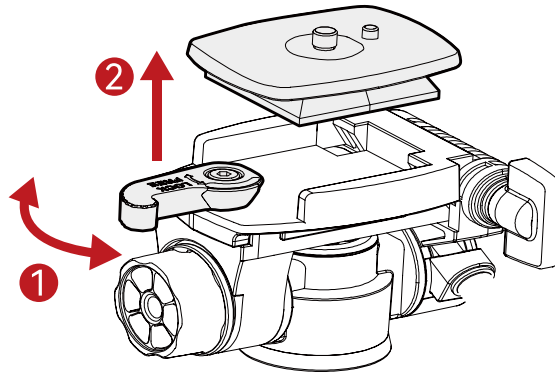

2. Attach the quick-release plate to the camera's 1/4" threaded hole, then snap the plate into the tripod mount.

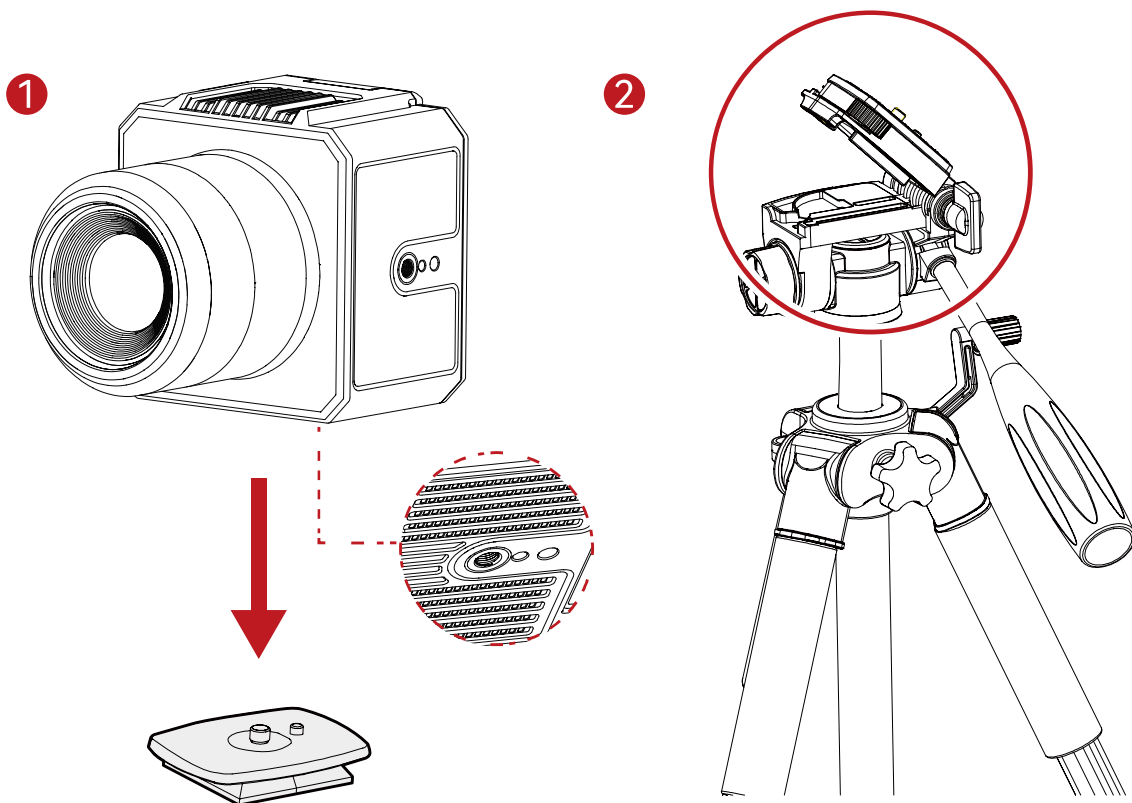

Accessory Usage

Connect Hollyland Microphone

- This port is for connecting Hollyland microphones only (other brands not supported).

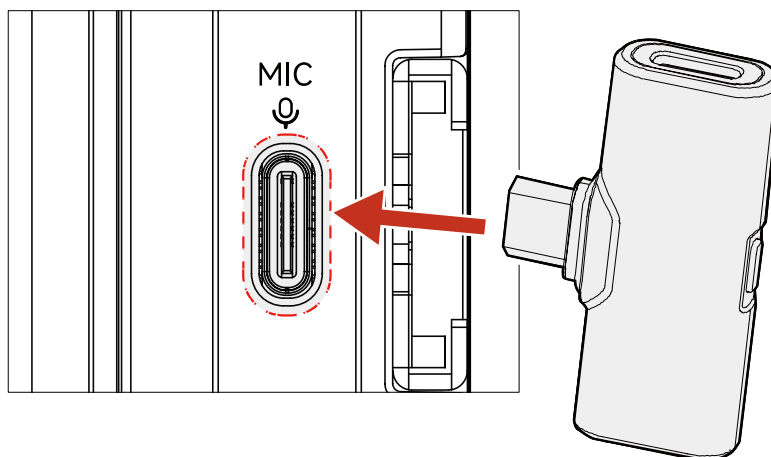

Insert SD Card

- Insert the SD card until you hear a click.
Ensure proper insertion to avoid malfunction.

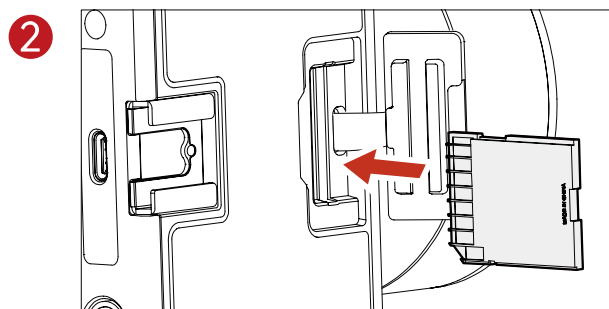
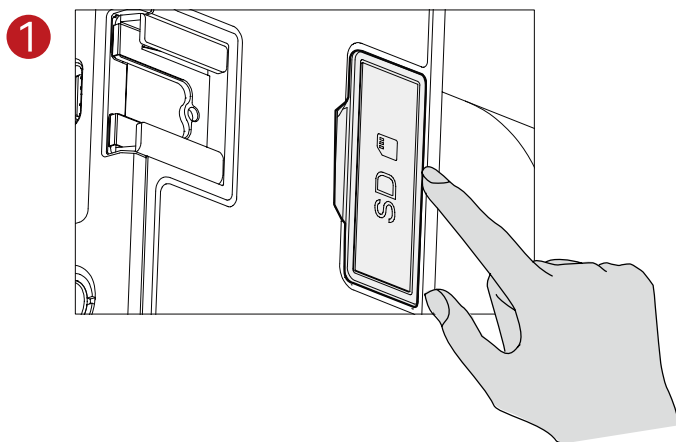

- To remove the SD card, press gently to eject it automatically.

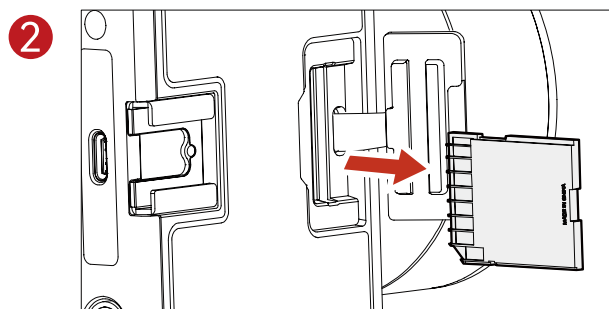
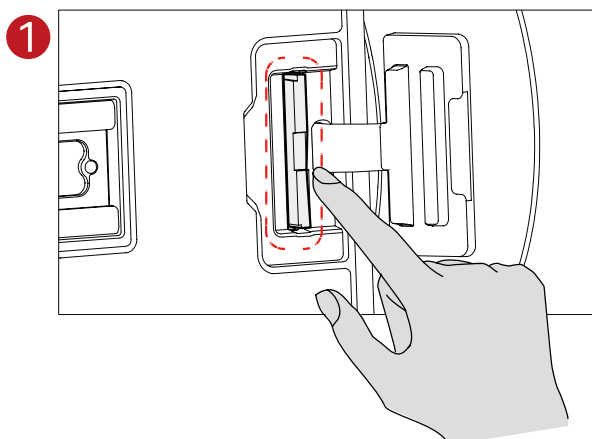

Specifications

| Type | Item | Description |
|------------------|----------------------|--|
| Basic Parameters | Model | VenusLiv Air |
| | Weight | 660g (+/-100g) (Camera body only) |
| | Dimensions | L*W*H: 134*97*101mm (+/-5mm) |
| | Focus | Hybrid autofocus (Phase + Contrast), supports continuous focus |
| | CMOS | 1/1.3-inch |
| | Effective Pixels | 50MP |
| | Lens | <ul style="list-style-type: none"> • 4K optical fixed-focus lens • Equivalent focal length 25mm • Aperture F1.05 (Equivalent F3.6) • 4x digital zoom • FOV: Diagonal: 84° Horizontal: 70° Vertical: 55° |
| | Ports | <ul style="list-style-type: none"> • DC IN: 5.5*2.1mm • HDMI OUT: HDMI 2.0 • USB-C: USB 3.0 • USB-C: Digital audio • 3.5mm jack • SD card slot • RJ45 network port |
| | Buttons | <ul style="list-style-type: none"> • Power button • REC button |
| | Video Output Formats | <ul style="list-style-type: none"> • Record 3840*2160/ 2160*3840 (30fps) 1920*1080/ 1080*1920 (30fps) 1280*720/720*1280 (30fps) • UVC (YUY2) 1920*1080 (30/60fps) • UVC (NV12) 3840*2160 (30fps) 1920*1080 (30/60fps) • UVC (MJPEG) 3840*2160 (30fps) 1920*1080 (30fps) • HDMI output 1920*1080 (60 Hz) • RTMP output 3840*2160 (30fps) 1920*1080 (30fps) 1280*720 (30fps) |
| | Touchscreen | 3.0-inch TFT, 480p |
| | Audio Input | UAC wireless MIC, 3.5mm analog MIC / LINE IN |
| | Audio Output | HDMI, UAC digital audio output |

Specifications

| Type | Item | Description |
|-------------|-----------------------|--|
| Wireless | WIFI+BT | Dual-band 2.4G + 5G Wi-Fi, Bluetooth 5.0 |
| Electrical | Power Consumption | MAX 10W |
| | DC Input Voltage | 12V 2A |
| Temperature | Operating Temperature | -10°C to 40°C |
| | Storage Temperature | -10°C to 60°C |

Warning:

If you fail to take the following precautions, you may be seriously injured or killed by the electric shock or fire disaster caused, or your VenusLiv Air may be damaged. Please check whether the camera and accessories are intact before using them. For security reasons, only Hollyland accessories that are provided with the camera or genuine ones purchased can be used. The use of any other parts, accessories, or chargers not recommended by Hollyland may cause fire disaster, electric shock, or personal injury. Damage caused by the use of unauthorized accessories is not covered by the warranty. For approved accessories, please visit the Hollyland official website at <https://www.hollyland.com>.

1. Do not touch the plug or adapter with wet hands when connecting the camera to the adapter. Failure to follow this precaution may cause electric shock.
2. Do not place or fix the camera on an unstable surface. Failure to follow this precaution may cause the camera to loosen or fall off, causing an accident or damage to the camera.
3. When using external power supply connection, please follow all the security rules of the third-party power supply device.
4. The lens of the VenusLiv Air is made of glass. If the lens is damaged, please handle it carefully to avoid being scratched by the broken lens/glass and keep it away from children.
5. The temperature of the camera may rise during operation. If this occurs, turn off the camera and leave it to cool before using it again.
6. This product is not a toy and you are solely responsible for complying with all local laws, regulations, and restrictions.
7. Do not use the VenusLiv Air for unauthorized monitoring, candid shooting, or in any way that violates personal privacy regulations. Normally, it is strictly forbidden to use the camera for such purposes. If you fail to follow this precaution, you may bear huge responsibilities and face criminal proceedings.
8. Do not put the camera in extremely cold or hot environments. Extremely cold or hot environments may cause the camera to temporarily stop working properly.

* Note:

There is no protection for the lens of the VenusLiv Air. If you do not pay attention to it, it is easy to cause scratches. Please store the VenusLiv Air in the provided box and avoid placing the lens on any surface. Lens scratches are not covered by the warranty.

Disclaimer





1. Please read and follow all operating instructions carefully.
2. Pay close attention to all safety warnings.
3. Do not operate this device near heat sources such as radiators, heaters, stoves, or other equipment that produces heat.
4. Use only accessories specified and provided by Hollyland Technology.
5. Refer all servicing to qualified personnel. Servicing is required when the device has been damaged in any way, such as a damaged power cord or plug, liquid ingress, foreign objects entering the device, exposure to rain or moisture, abnormal operation, or being dropped.

Safety Precautions

Do not place the device near or inside heating appliances, cooking equipment, or pressurized containers (such as microwave ovens, induction cookers, electric ovens, space heaters, pressure cookers, water heaters, or gas stoves), to prevent the battery from overheating or exploding. Always use the original, manufacturer-supplied charger, data cable, and battery that match the specified model. Using uncertified or non-matching chargers, cables, or batteries may result in electric shock, fire, explosion, or other hazards.

Support

If you encounter any problems in using the product or need any help, please contact Hollyland Support Team via the following ways:

-  Hollyland User Group
-  HollylandTech
-  HollylandTech
-  HollylandTech
-  support@hollyland.com
-  www.hollyland.com

Statement:

All copyrights belong to Shenzhen Hollyland Technology Co., Ltd. Without the written approval of Shenzhen Hollyland Technology Co., Ltd., no organization or individual may copy or reproduce part or all of any written or illustrative content and disseminate it in any form.

Trademark Statement:

All the trademarks are owned by Shenzhen Hollyland Technology Co., Ltd.

Note:

Due to product version upgrades or other reasons, this Quick Guide will be updated from time to time. Unless otherwise agreed, this document is provided as a guide for use only. All representations, information, and recommendations in this document do not constitute warranties of any kind, express or implied.

HOLLYVIEW

Powered by Hollyland

